



**CITY OF BLACK DIAMOND**  
**April 30, 2009 Workstudy Agenda**  
25510 Lawson St., Black Diamond, Washington

Workstudies are meetings for Council to review upcoming and pertinent business of the City. Public testimony is only accepted at the discretion of the Council

**7:00 P.M. – CALL TO ORDER, ROLL CALL**

- 1.) Street Standards – Mr. Boettcher
- 2.) Adjournment

## SR -169

- A 5 lane section is not needed for the build out of Black Diamond as currently planned. However the state is planning a 5 lane section north of 188<sup>th</sup>. Looking out 50 years a 5 lane section could be needed. Should the City plan for a 5 lane section north of Roberts Drive? By planning for a 5 lane section the City would at a minimum require new buildings to be set back for the future roadway. Another step the City could take would be to acquire the right of way through the development process over the next 50 years.

-

## 5-LANE SECTION NORTH OF ROBERTS DR. SR-169

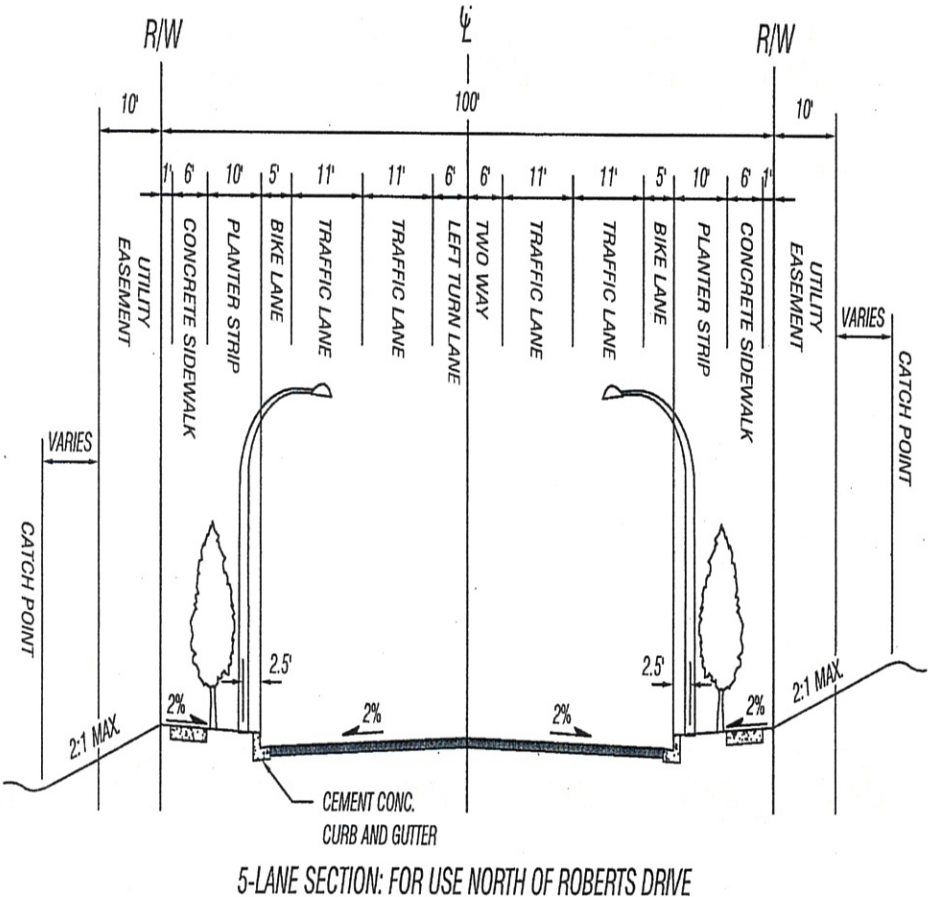

## SR -169

- Although a 3 lane roadway with bike lanes and sidewalks will not currently fit between the existing buildings through the downtown area, a left hand turn lane at Baker and Lawson will be needed to handle the traffic. There are multiple points of direct access along the downtown area where a three lane section would provide the best traffic service
- Start thinking about street trees. Notice that I included them on the wider street section north of Roberts Drive, but not through old down town because of width issues.



## SR-169 & BAKER SOUTH BOUND

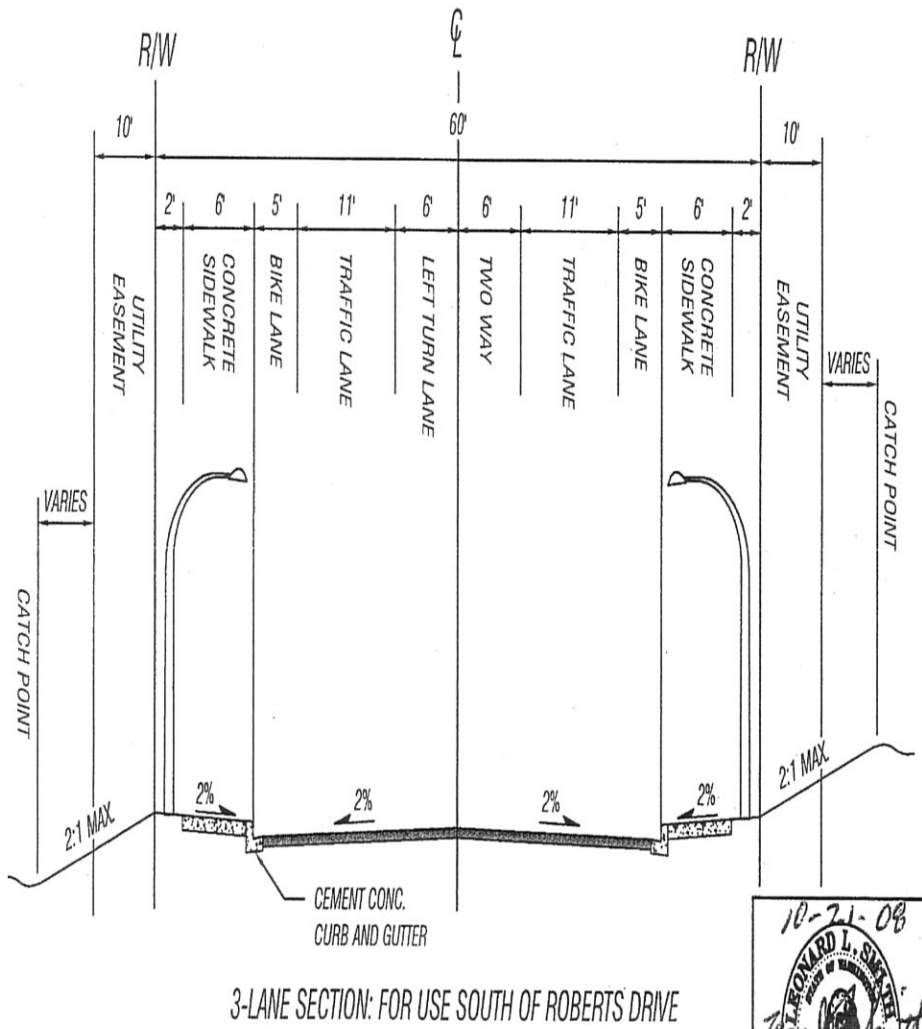

## SR-169 & BAKER NORTH

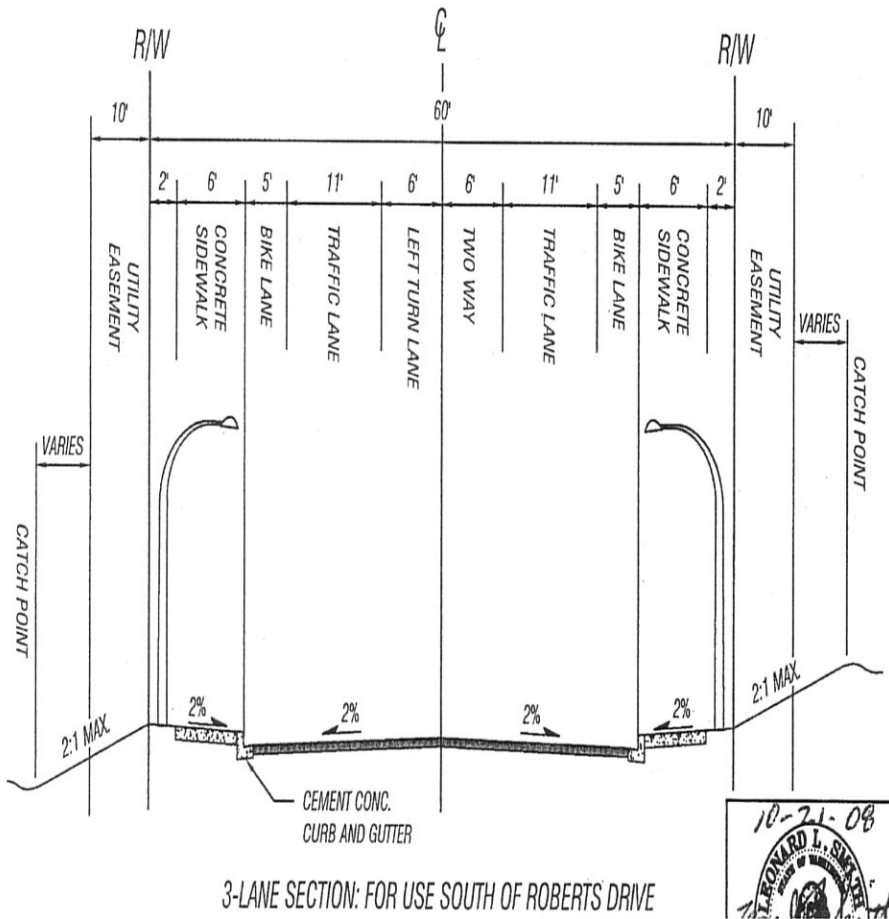

## **Minor Arterial**

- The City's minor arterial are: Roberts Drive, Lake Sawyer Drive, 196<sup>th</sup>, Lawson Street, Pipeline Road, North Connector, Villages Spine Road, Lawson Boulevard, ect.
- The staff is recommending a two lane section from SR 169 to Morgan street because there is limited direct access point along this section.
- Notice that bike lanes are shown on our minor arterial sections. Notice that they are 5 foot lanes. This would be a striped dedicated bike lane. Another option that is commonly is a shared multi use lane. A designated bicycle route on a shared lane facility utilizes extra wide lanes for bicycles typically 14 or 15 feet.

## MINOR ARTERIAL WITH NO TWO WAY TURN LANE

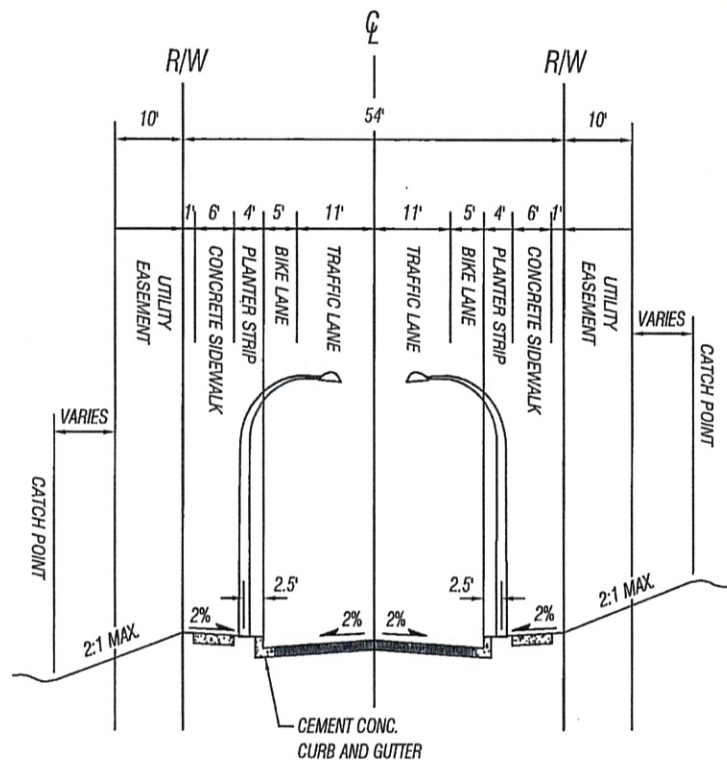



# PRINCIPAL ARTERIAL

# 104' ROW BLVD LAWSON HILLS

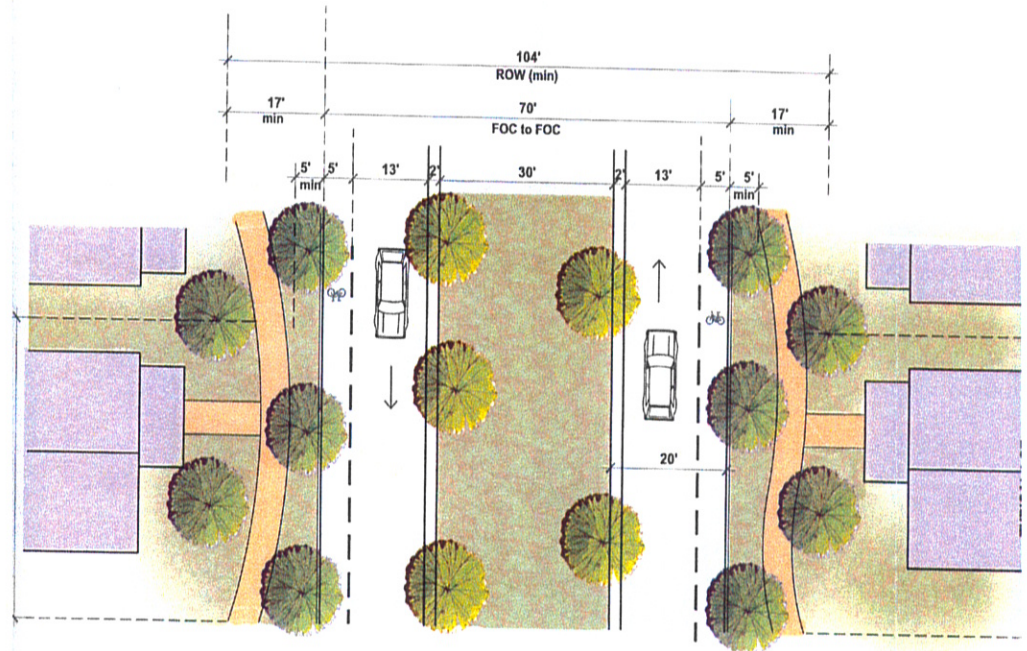
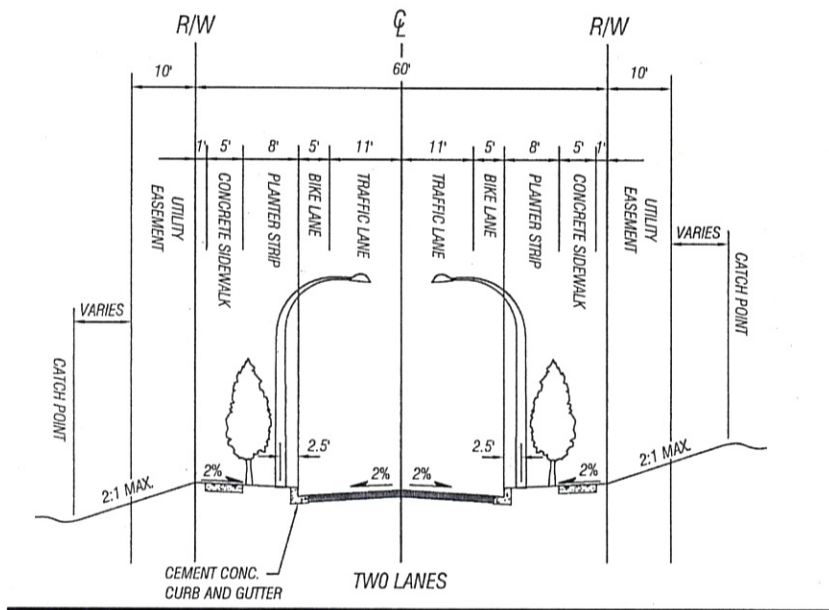

## MINOR ARTERIAL

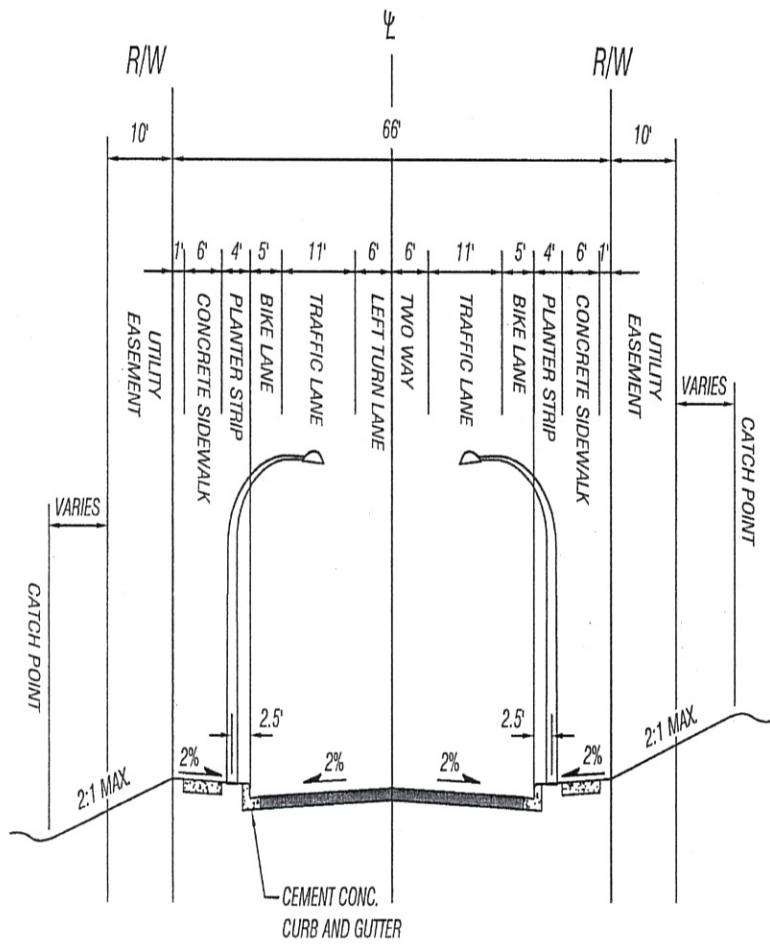

## 104' ROW BLVD. TOWN CENTER

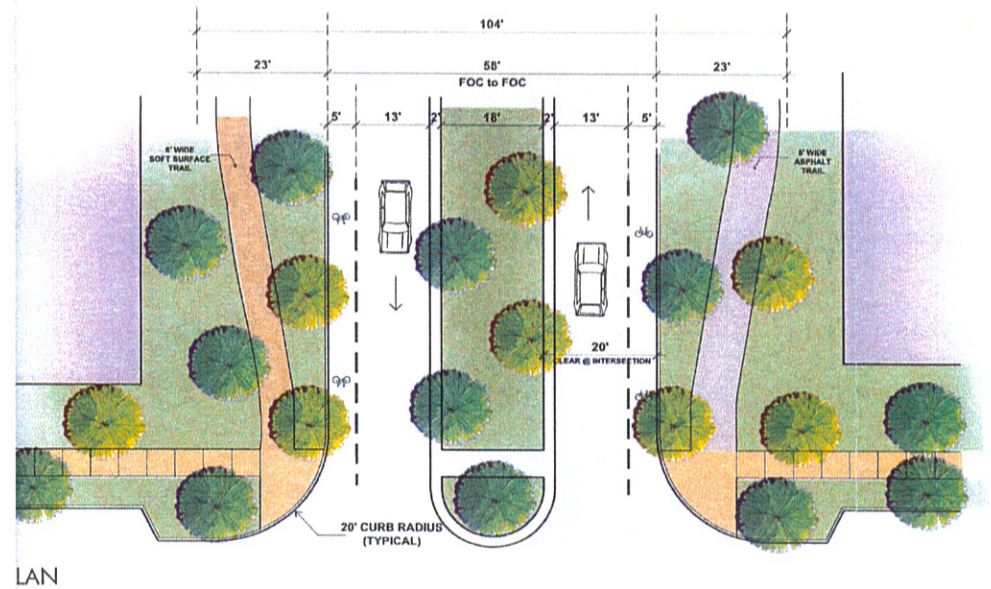



## NEIGHBORHOOD COLLECTOR

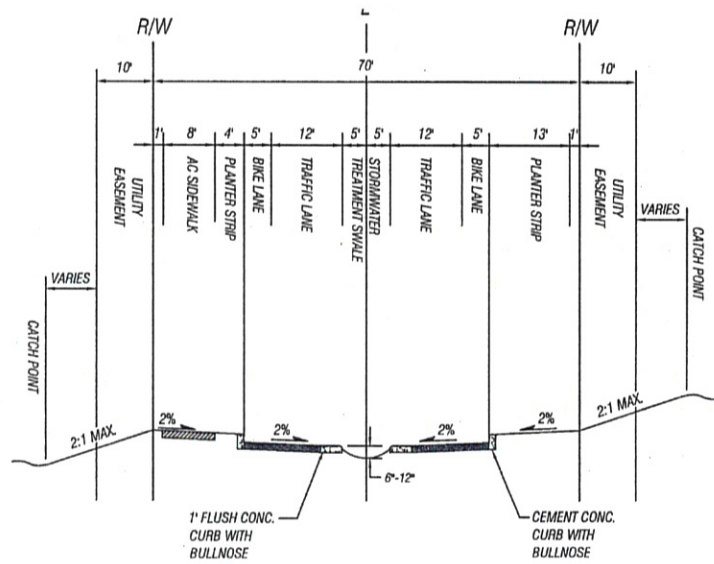

## 60' ROW COMMUNITY COLLECTOR

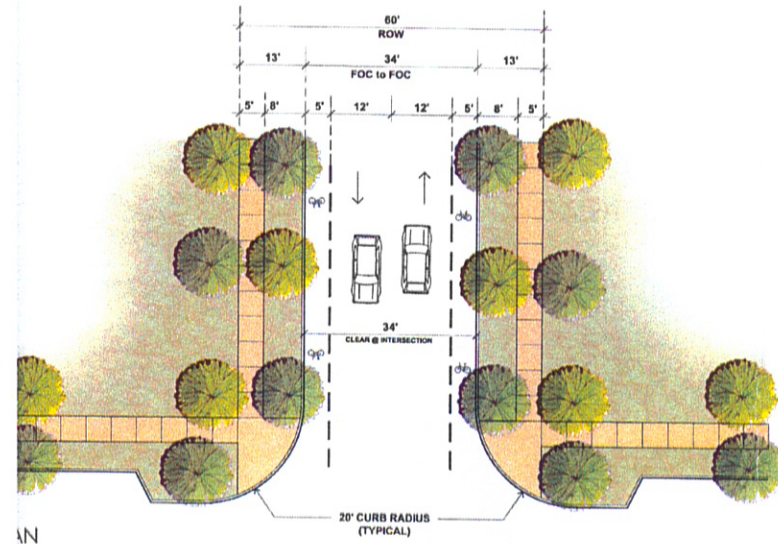

62' ROW

10' 42' 10'

FOC to FOC

5' 5' 7' 4' 10' 10' 4' 7' 5' 5'

30' CLEAR @ INTERSECTION

17' CURB RADIUS (TYPICAL)

The diagram illustrates a street intersection with a 17-foot typical curb radius. The overall Right-of-Way (ROW) is 62 feet wide. The distance from the Focus of Curvature (FOC) to the FOC for the intersecting street is 42 feet. The intersection is marked with a 30-foot clear zone. The diagram shows the layout of the road, including the 17-foot curb radius, the 30-foot clear intersection, and the 17-foot curb radius (typical) for the intersecting street. The diagram also shows the placement of trees and the 10-foot distance from the FOC to the FOC.

## LOCAL ACCESS COMMERCIAL

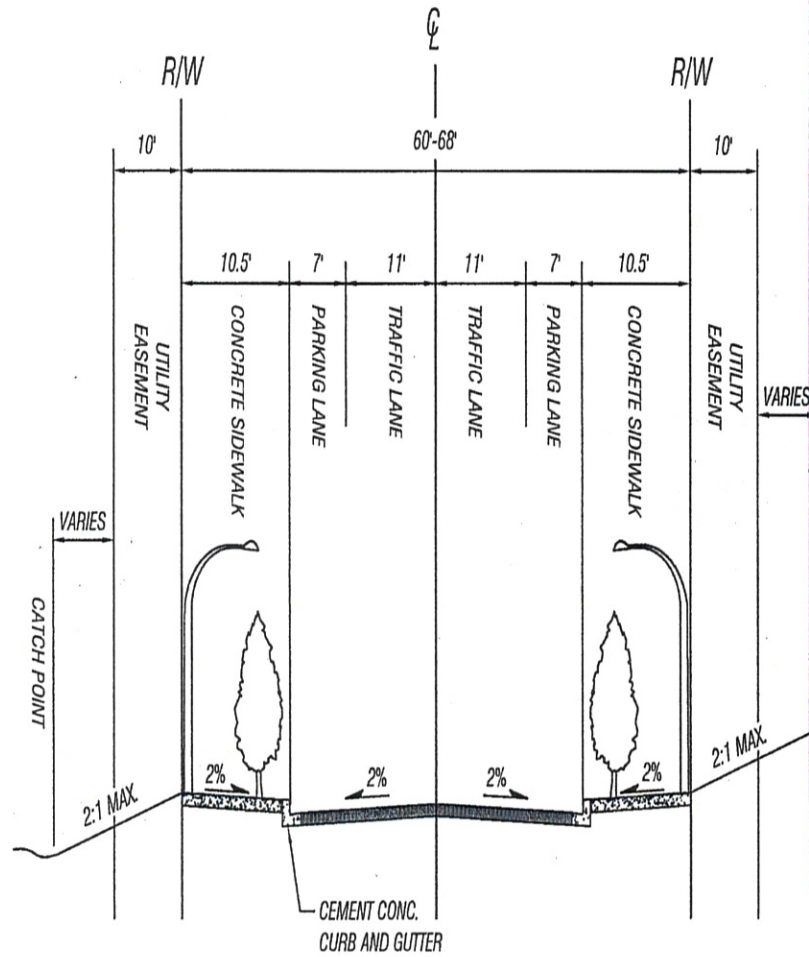

## 24' RIGHT OF WAY MAIN STREET

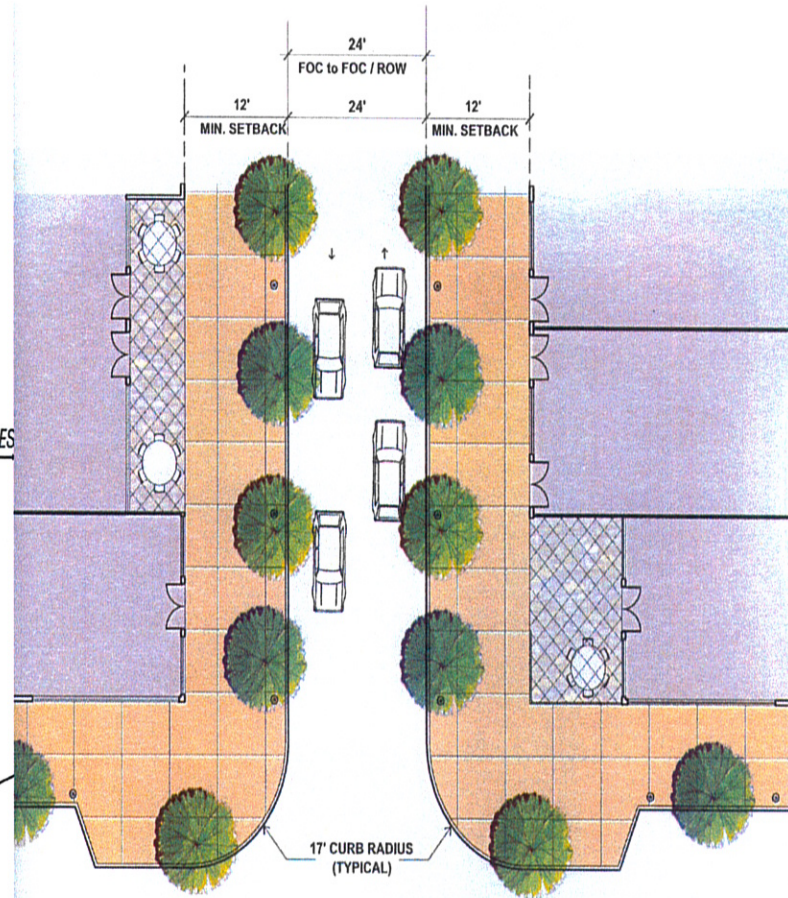



# LOCAL ACCESS COMMERCIAL

# 36' ROW MAIN STREET

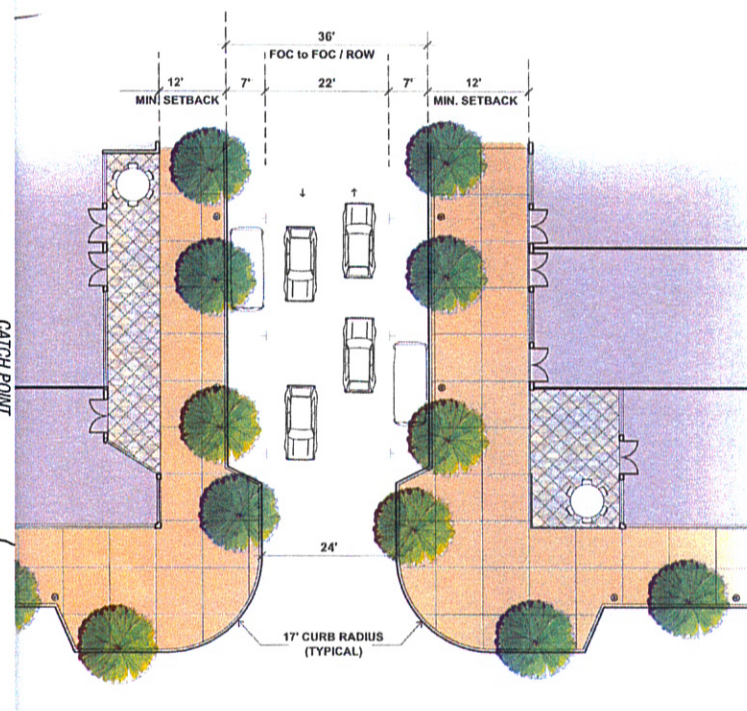
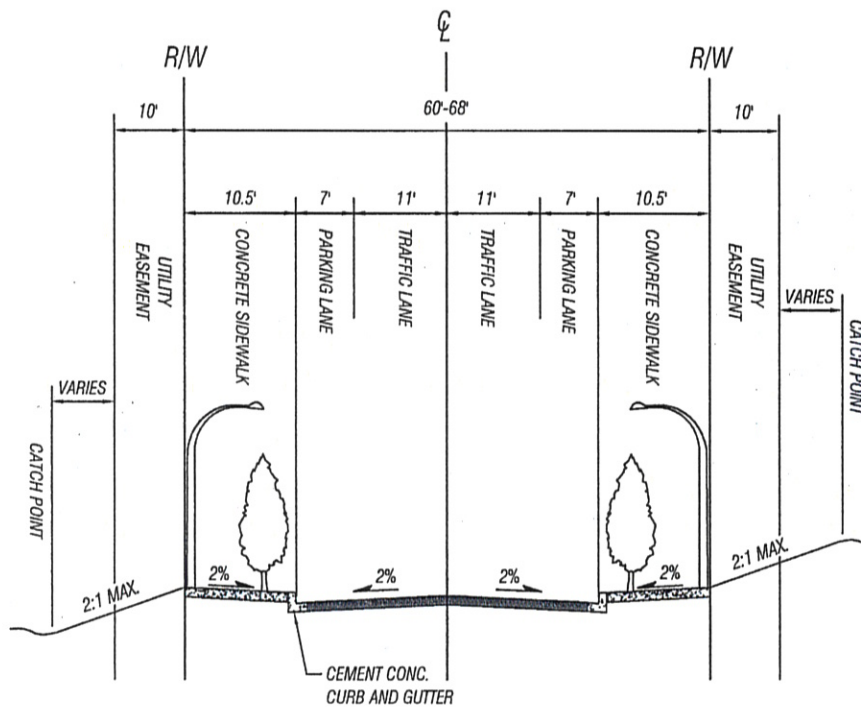

## 47' ROW MAIN STREET

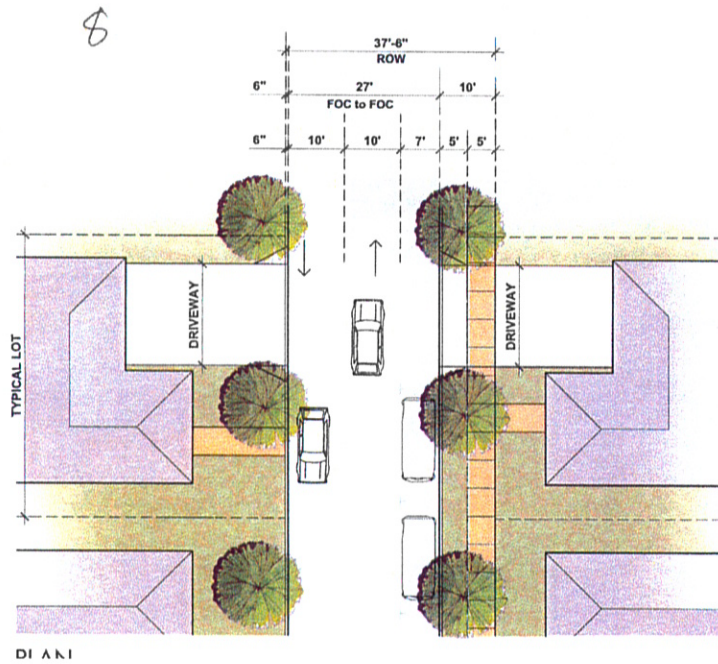

## 60' ROW MAIN STREET

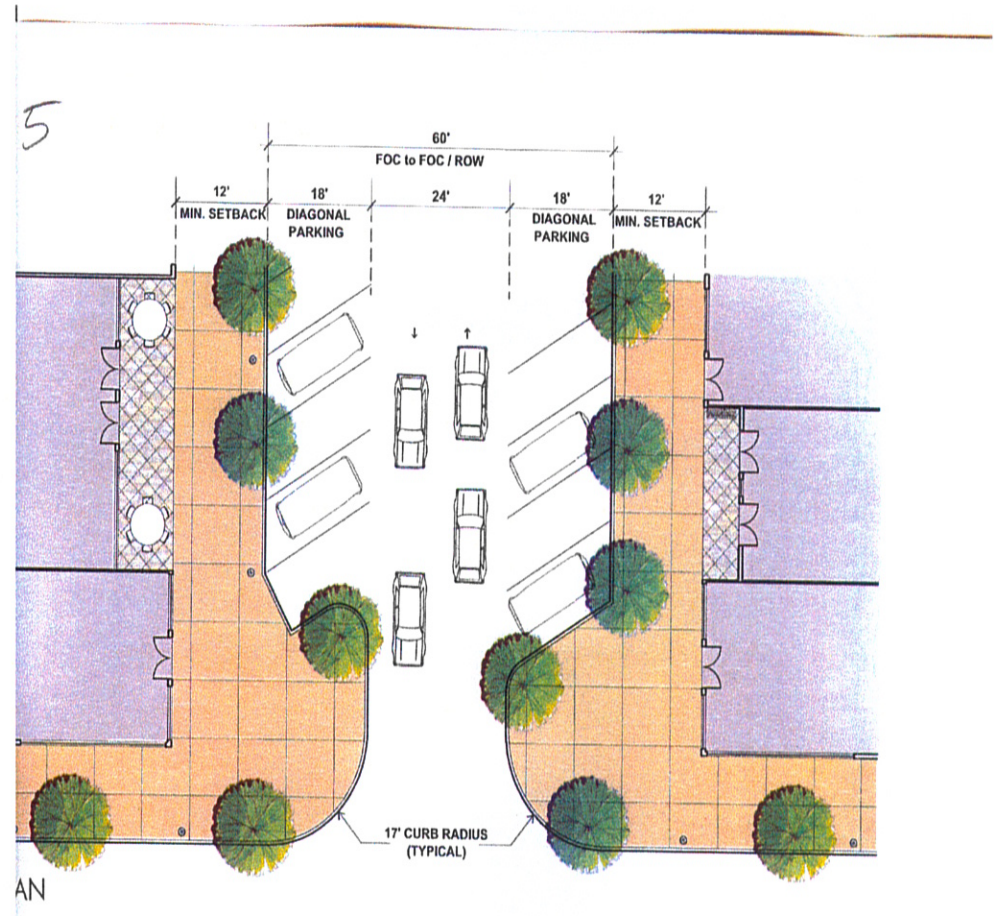

## LOCAL ACCESS RESIDENTIAL ON STREET PARKING

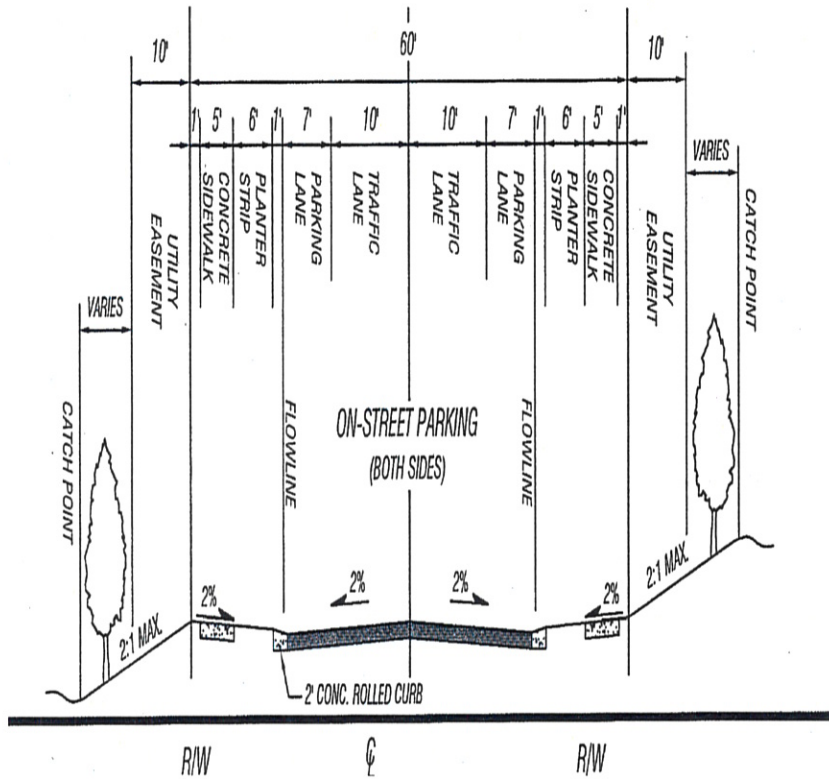

## 62' ROW NEIGHBORHOOD STREET PARKING BOTH SIDES OF STREET

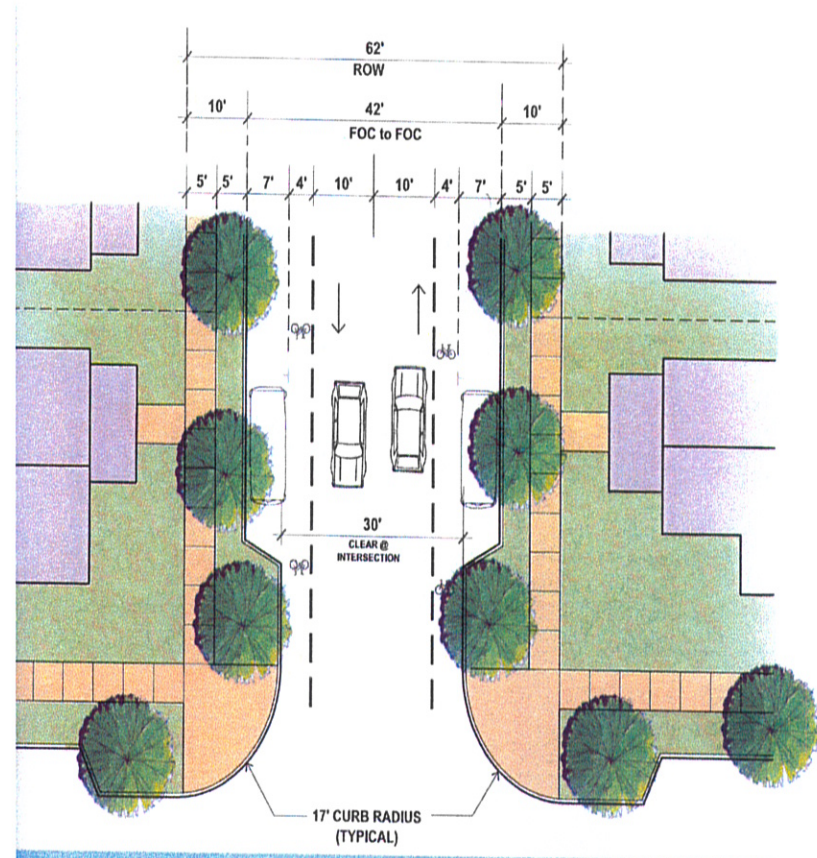



# LOCAL ACCESS RESIDENTIAL PARKING ONE SIDE OF STREET

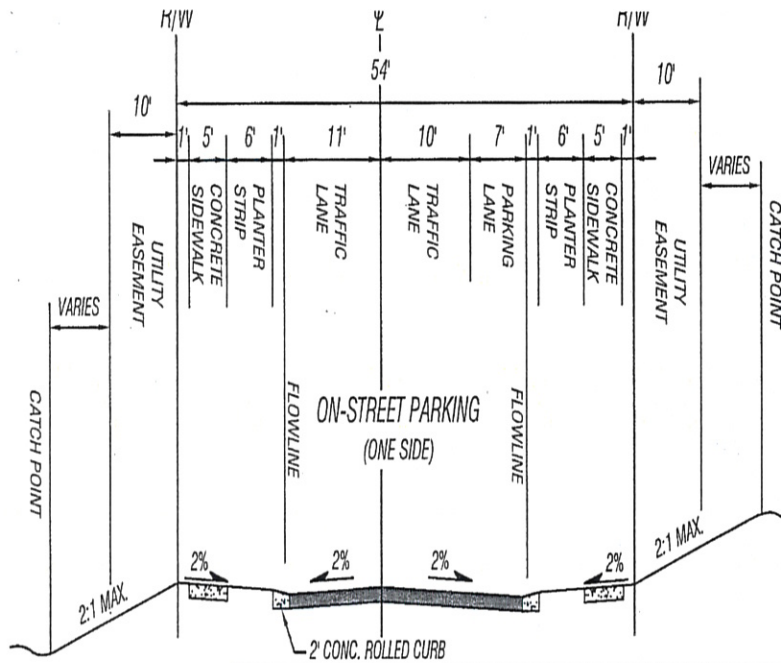

# 50' ROW NEIGHBORHOOD STREET PARKING ONE SIDE OF STREET

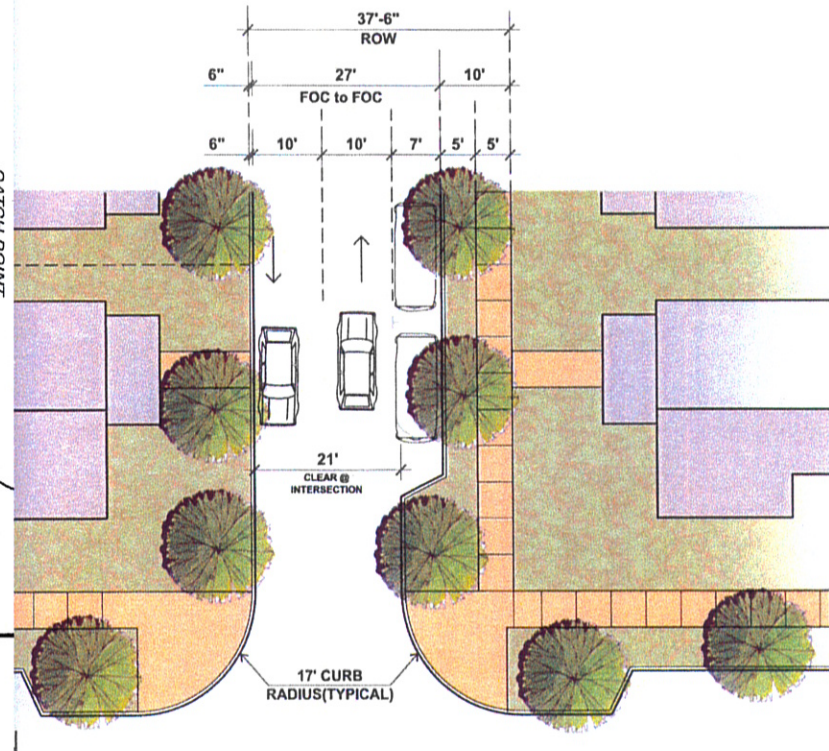

## ALLEY SECTION

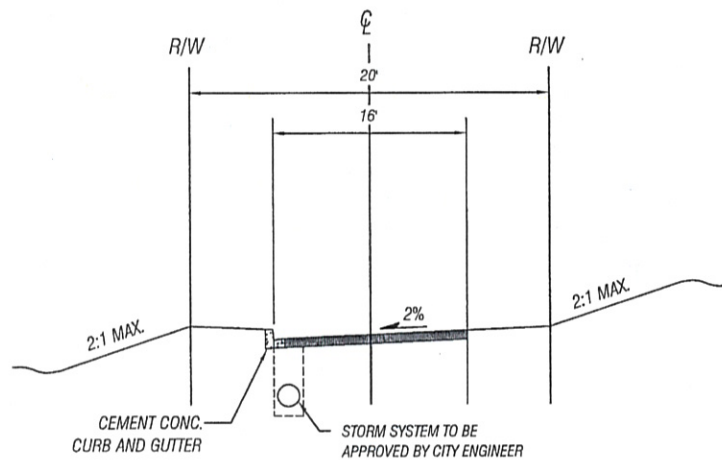

## 20' ROW RESIDENTIAL ALLEY

PLAN

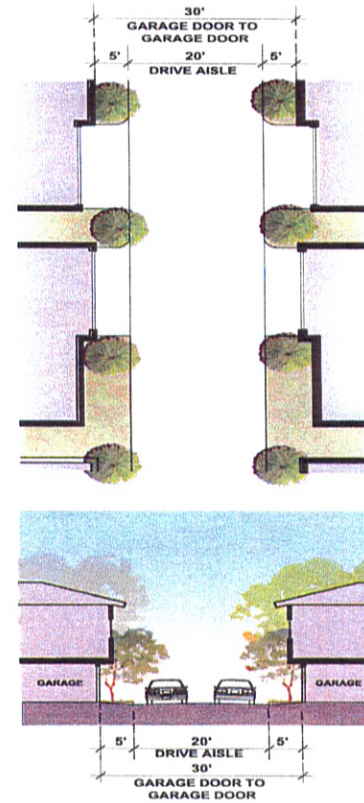

## CUL-DE-SAC

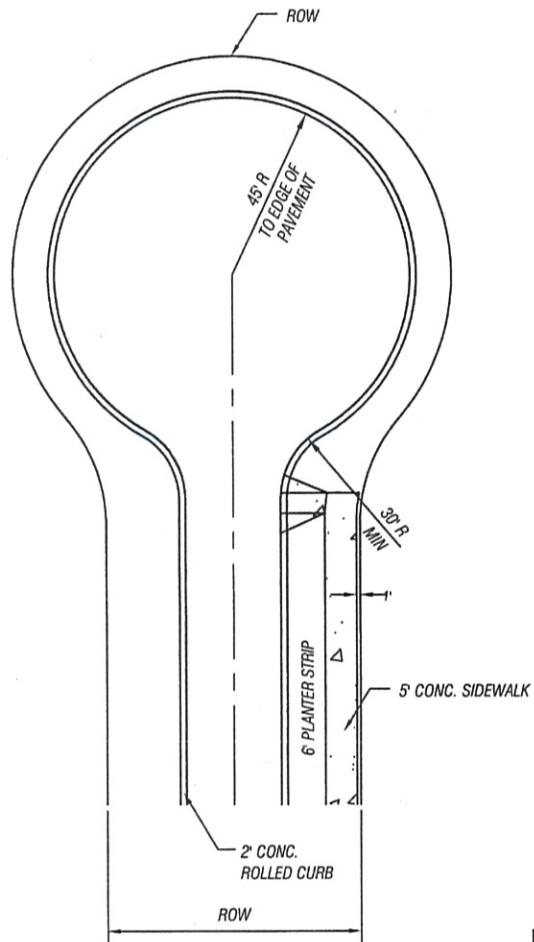

70

## CUL-DE-SAC

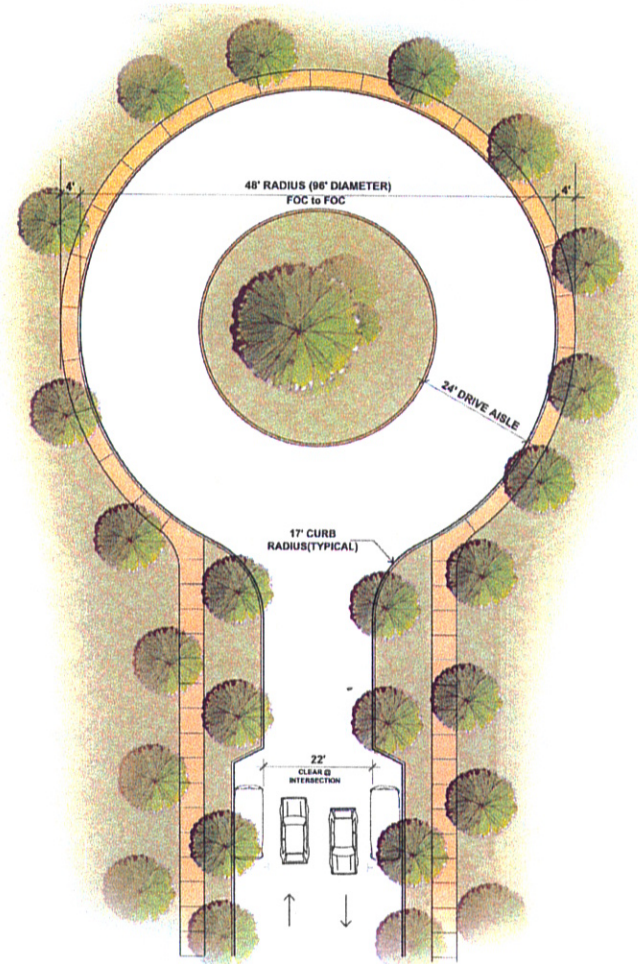



## CUL-DE-SAC

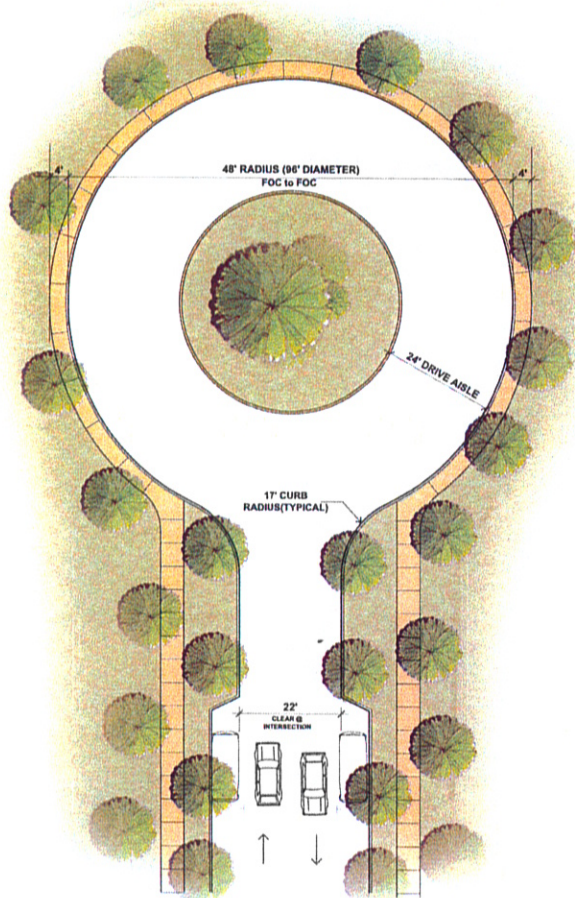

## HAMMERHEAD

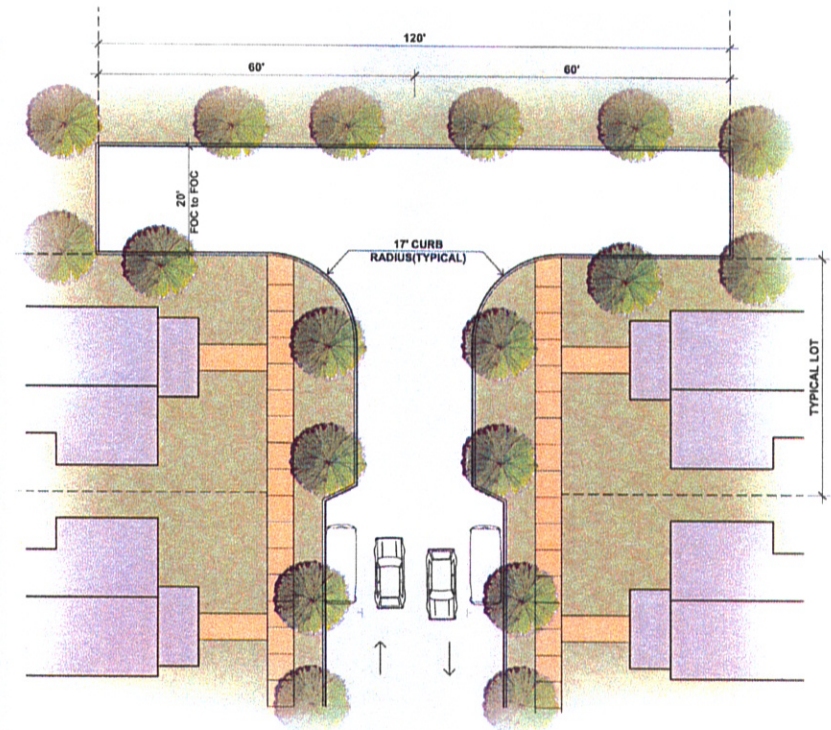

CUL-DE-SAC

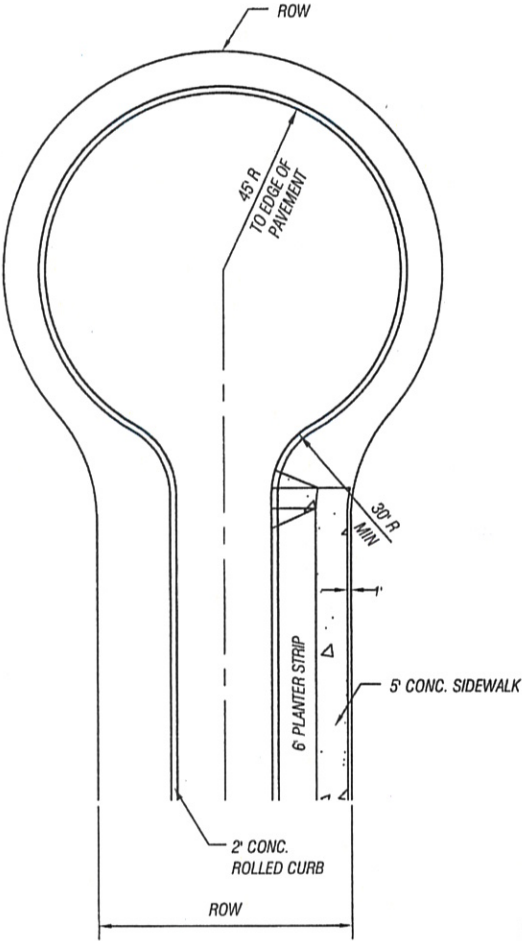

70

CUL-DE-SAC

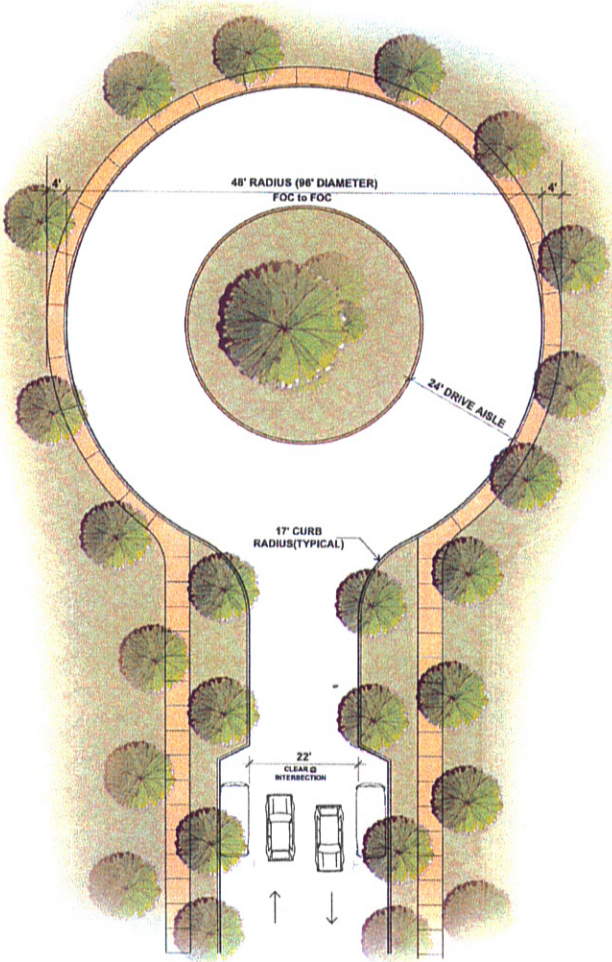



CITY OF BLACK DIAMOND  
LOCAL STREET SURVEY AND DESIGN  
STANDARD RECOMMENDATION STUDY

PadWest Engineering  
5009 Pacific Hwy E, Unit 910  
Fife, WA 98424  
(253) 923-3400



March 2009



## **BACKGROUND & PURPOSE**

PacWest Engineering was authorized by the Black Diamond City Council to conduct a transportation study of the existing roadways within the City of Black Diamond. The need for this study was identified following a Council work session regarding the draft transportation development standards that have been developed for the City.

PacWest Engineering had prepared updated Development Standards for the City which were developed to address the new growth that the City is anticipating, rather than infill development throughout the existing City. Members of the Black Diamond Council expressed concerns with how the proposed development standards would apply to existing local roadways within the City. As a result of Council's concerns, PacWest Engineering was directed to conduct a local street survey and design standard recommendation study to evaluate the City's existing streets and to determine the appropriate course of action should development occur along these facilities.

## **SCOPE OF STUDY**

The scope of the study included completing an inventory of existing City streets. Specific features were documented such as right-of-way widths, existing street pavement widths, drainage system (enclosed or open), and status of curbs, sidewalks, and bikepaths. PacWest Engineering developed a classification of existing streets for incorporation into the Transportation Element of the City of Black Diamond's Comprehensive Plan and assigned typical street requirements to the existing local streets from the previously collected and developed information.

## **REVIEW OF EXISTING FACILITIES**

PacWest Engineering has completed a field inventory of the existing City streets. Two spreadsheets have been provided which summarize the findings; one for local streets and one for roadways classified as collectors, minor arterials, or principal arterials.

Categories of data collected include the following fields:

- Street Name
- From Street
- To Street
- Right-of-Way Width
- Pavement Width
- Roadway Surface Type
- Drainage Type
- Curb
- Pedestrian Facilities
- On Street Parking
- Bicycle Facilities
- Power
- Street Classification

The condition of the existing local roads varies greatly. Right-of-way widths vary from twenty feet to eighty feet. Pavement widths vary from nine to forty feet.

## **RECOMMENDATION FOR IMPROVEMENTS**

PacWest Engineering has developed five standard street sections to be assigned to roadways classified as "local streets". These sections vary based on proposed pavement width. They each propose an asphalt wedge curb on both sides for wider roadways and on one side for the narrower streets. Sidewalks are not proposed to be added to any local streets where they do not presently exist.



Additionally, there are numerous local roadways that are currently developed to standards greater than the proposed typical sections. For these roadways we have recommended "no change" and that the existing section is appropriate for development occurring in these locations.

There are several unopened right-of-ways throughout town and these are recommended to be evaluated on a case by case basis should development occur in these areas. The level of improvement in these areas will depend greatly on the size and scope of any proposed development.

### **ADOPTION PROCESS**

PacWest Engineering recommends that this report and our findings be forwarded to the appropriate City of Black Diamond City Council Committee for review and recommendation to the full Council.

### **ATTACHMENTS**

1. Black Diamond Street Inventory (Collectors, Minor Arterials, Principal Arterials)
2. Black Diamond Street Inventory and Typical Section Recommendations (Local Streets)
3. Typical Street Sections



# IN-FILL DEVELOPMENT IN DEVELOPED PORTIONS OF OLD BLACK DIAMOND

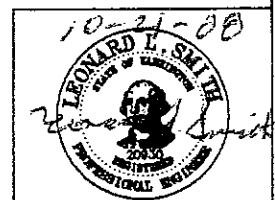
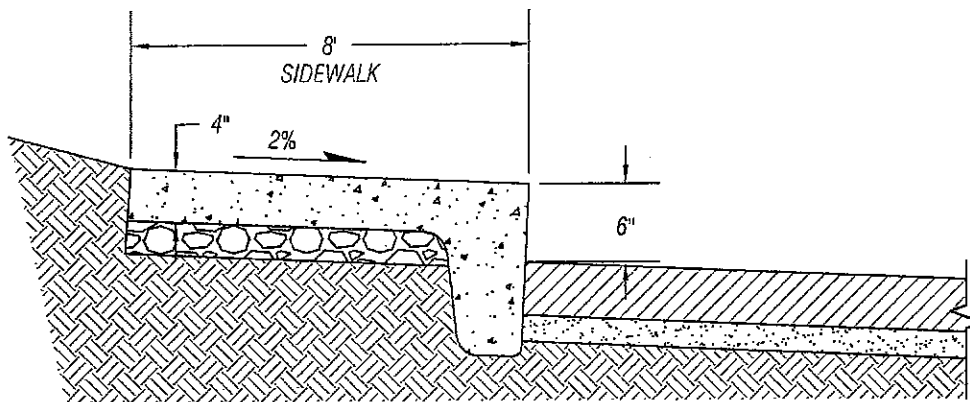

CITY OF  
BLACK DIAMOND

IN-FILL SECTION 3

STANDARD DWG TR-26

NOT TO SCALE

10/01/08



PacWest Engineering  
Fife, Washington

# IN-FILL DEVELOPMENT IN DEVELOPED PORTIONS OF OLD BLACK DIAMOND

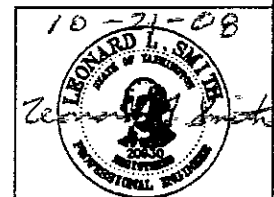
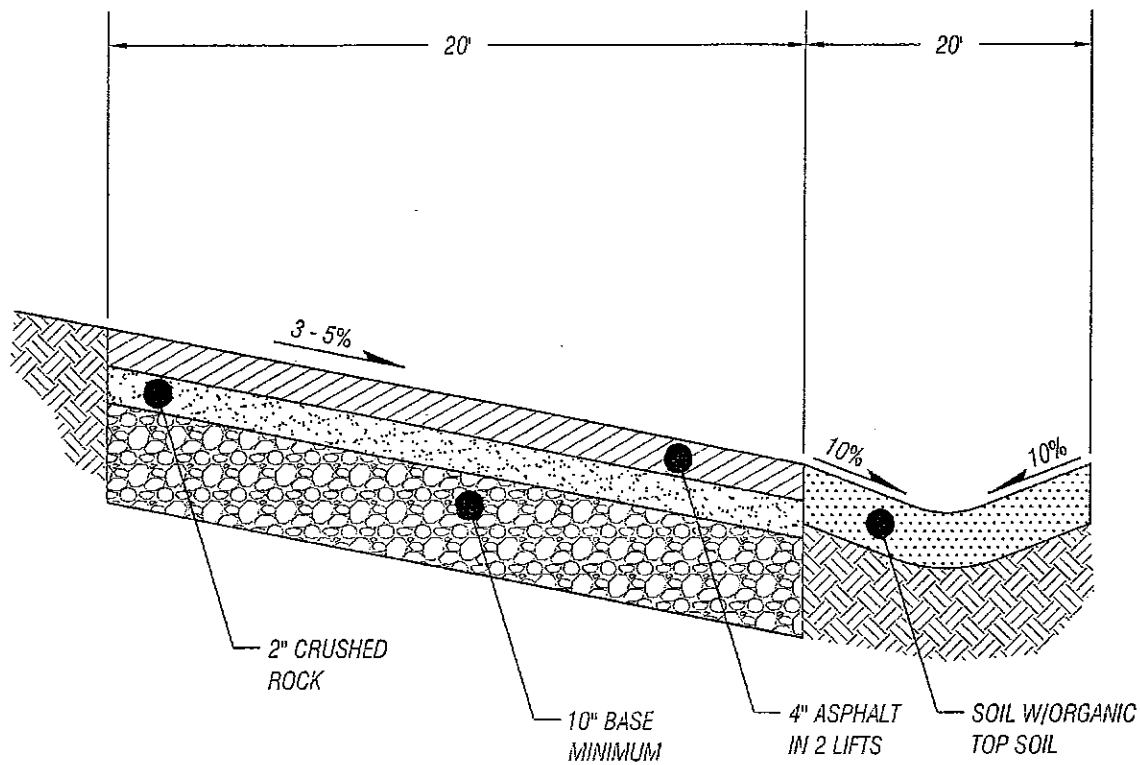

CITY OF  
BLACK DIAMOND

## IN-FILL SECTION 2

STANDARD DWG TR-25

NOT TO SCALE

10/01/08



# IN-FILL DEVELOPMENT IN DEVELOPED PORTIONS OF OLD BLACK DIAMOND

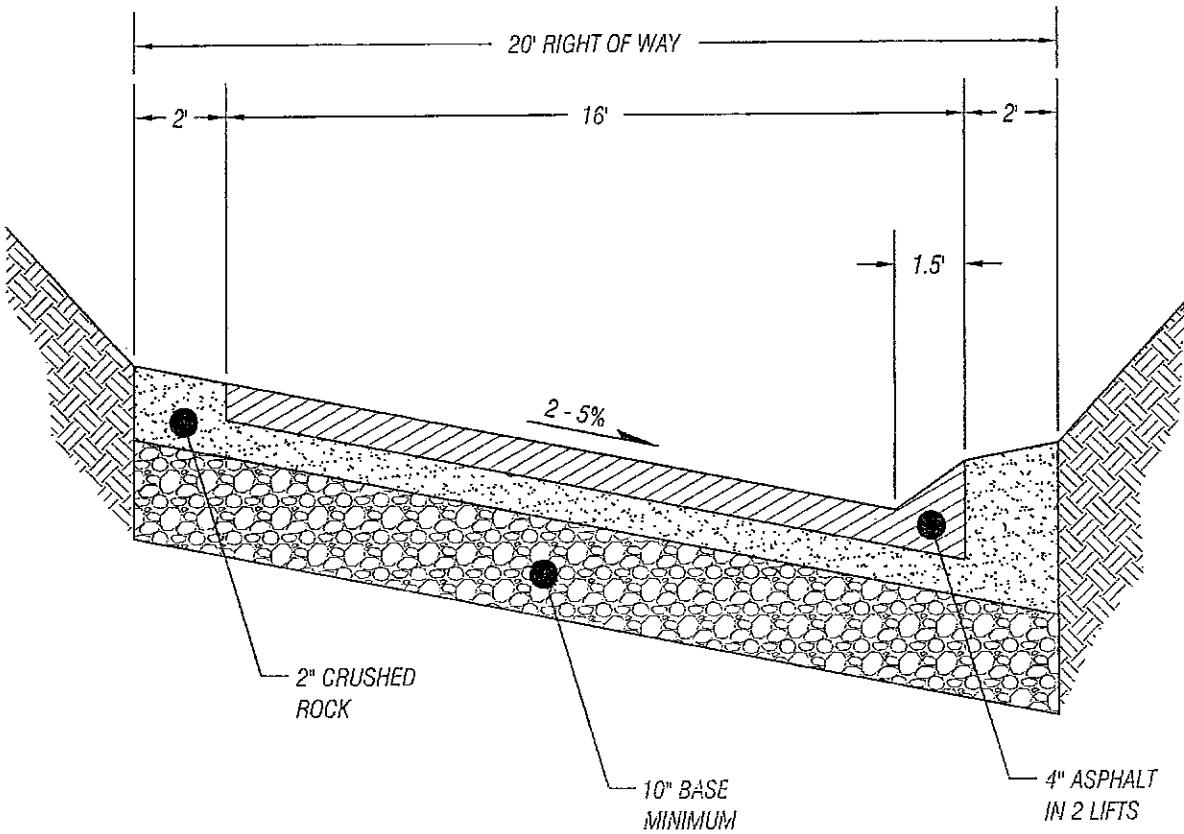

CITY OF  
BLACK DIAMOND

IN-FILL SECTION 1

STANDARD DWG TR-24

NOT TO SCALE

10/01/08



PacWest Engineering  
Fife, Washington

**STREET SECTION  
ST-12**

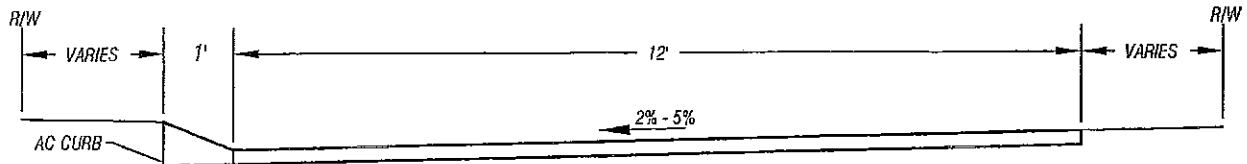

**STREET SECTION  
ST-16**

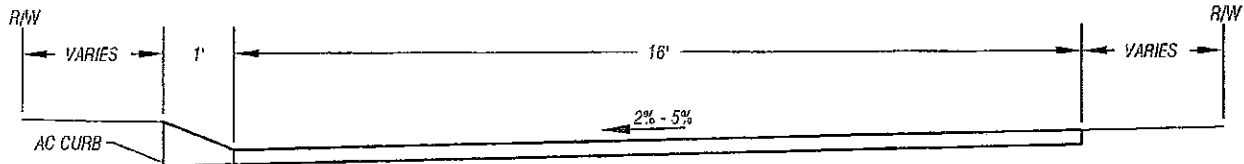

**STREET SECTION  
ST-20**

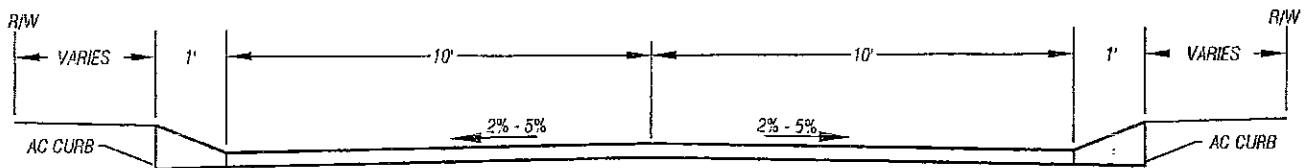

**STREET SECTION  
ST-24**

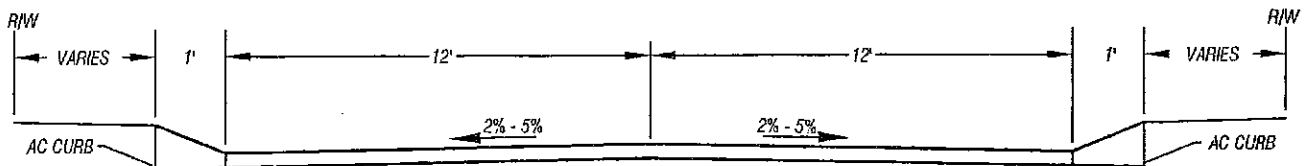

**STREET SECTION  
ST-30**

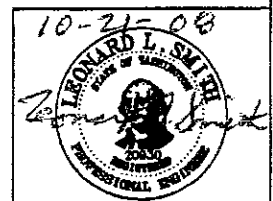
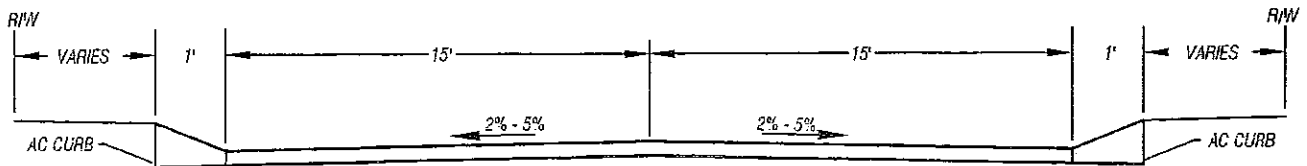

**CITY OF  
BLACK DIAMOND**

**IN-FILL DEVELOPMENT  
STREET SECTIONS**

STANDARD DWG TR-23

NOT TO SCALE

10/01/08



**PacWest Engineering**  
Fife, Washington



NOT TO SCALE

DOWN TOWN AREA

26TH AVE SE

25TH AVE SE

24TH AVE SE

23RD AVE SE

22ND AVE SE

21ST AVE SE

20TH AVE SE

19TH AVE SE

18TH AVE SE

17TH AVE SE

16TH AVE SE

15TH AVE SE

14TH AVE SE

13TH AVE SE

12TH AVE SE

11TH AVE SE

10TH AVE SE

9TH AVE SE

8TH AVE SE

7TH AVE SE

6TH AVE SE

5TH AVE SE

4TH AVE SE

3RD AVE SE

2ND AVE SE

1ST AVE SE

26TH ST SE

25TH ST SE

24TH ST SE

23RD ST SE

22ND ST SE

21ST ST SE

20TH ST SE

19TH ST SE

18TH ST SE

17TH ST SE

16TH ST SE

15TH ST SE

14TH ST SE

13TH ST SE

12TH ST SE

11TH ST SE

10TH ST SE

9TH ST SE

8TH ST SE

7TH ST SE

6TH ST SE

5TH ST SE

4TH ST SE

3RD ST SE

2ND ST SE

1ST ST SE

MINOR ST

RAILROAD AVE

COMMISSION AVE

BAKER ST

1ST AVE

2ND AVE

3RD AVE

4TH AVE

5TH AVE

6TH AVE

7TH AVE

8TH AVE

9TH AVE

10TH AVE

11TH AVE

12TH AVE

13TH AVE

14TH AVE

15TH AVE

16TH AVE

17TH AVE

18TH AVE

19TH AVE

20TH AVE

21ST AVE

22ND AVE

23RD AVE

24TH AVE

25TH AVE

26TH AVE

26TH ST

25TH ST

24TH ST

23TH ST

22TH ST

21TH ST

20TH ST

19TH ST

18TH ST

17TH ST

16TH ST

15TH ST

14TH ST

13TH ST

12TH ST

11TH ST

10TH ST

9TH ST

8TH ST

7TH ST

6TH ST

5TH ST

4TH ST

3RD ST

2ND ST

1ST ST

MINOR ST

RAILROAD AVE

COMMISSION AVE

BAKER ST

1ST AVE

2ND AVE

3RD AVE

4TH AVE

5TH AVE

6TH AVE

7TH AVE

8TH AVE

9TH AVE

10TH AVE

11TH AVE

12TH AVE

13TH AVE

14TH AVE

15TH AVE

16TH AVE

17TH AVE

18TH AVE

19TH AVE

20TH AVE

21ST AVE

22ND AVE

23RD AVE

24TH AVE

25TH AVE

26TH AVE

26TH ST

25TH ST

24TH ST

23TH ST

22TH ST

21TH ST

20TH ST

19TH ST

18TH ST

17TH ST

16TH ST

15TH ST

14TH ST

13TH ST

12TH ST

11TH ST

10TH ST

9TH ST

8TH ST

7TH ST

6TH ST

5TH ST

4TH ST

3RD ST

2ND ST

1ST ST

MINOR ST

RAILROAD AVE

COMMISSION AVE

BAKER ST

1ST AVE

2ND AVE

3RD AVE

4TH AVE

5TH AVE

6TH AVE

7TH AVE

8TH AVE

9TH AVE

10TH AVE

11TH AVE

12TH AVE

13TH AVE

14TH AVE

15TH AVE

16TH AVE

17TH AVE

18TH AVE

19TH AVE

20TH AVE

21ST AVE

22ND AVE

23RD AVE

24TH AVE

25TH AVE

26TH AVE

26TH ST

25TH ST

24TH ST

23TH ST

22TH ST

21TH ST

20TH ST

19TH ST

18TH ST

17TH ST

16TH ST

15TH ST

14TH ST

13TH ST

12TH ST

11TH ST

10TH ST

9TH ST

8TH ST

7TH ST

6TH ST

5TH ST

4TH ST

3RD ST

2ND ST

1ST ST

MINOR ST

RAILROAD AVE

COMMISSION AVE

BAKER ST

1ST AVE

2ND AVE

3RD AVE

4TH AVE

5TH AVE

6TH AVE

7TH AVE

8TH AVE

9TH AVE

10TH AVE

11TH AVE

12TH AVE

13TH AVE

14TH AVE

15TH AVE

16TH AVE

17TH AVE

18TH AVE

19TH AVE

20TH AVE

21ST AVE

22ND AVE

23RD AVE

24TH AVE

25TH AVE

26TH AVE

26TH ST

25TH ST

24TH ST

23TH ST

22TH ST

21TH ST

20TH ST

19TH ST

18TH ST

17TH ST

16TH ST

15TH ST

14TH ST

13TH ST

12TH ST

11TH ST

10TH ST

9TH ST

8TH ST

7TH ST

6TH ST

5TH ST

4TH ST

3RD ST

2ND ST

1ST ST

MINOR ST

RAILROAD AVE

COMMISSION AVE

BAKER ST

1ST AVE

2ND AVE

3RD AVE

4TH AVE

5TH AVE

6TH AVE

7TH AVE

8TH AVE

9TH AVE

10TH AVE

11TH AVE

12TH AVE

13TH AVE

14TH AVE

15TH AVE

16TH AVE

17TH AVE

18TH AVE

19TH AVE

20TH AVE

21ST AVE

22ND AVE

23RD AVE

24TH AVE

25TH AVE

26TH AVE

26TH ST

25TH ST

24TH ST

23TH ST

22TH ST

21TH ST

20TH ST

19TH ST

18TH ST

17TH ST

16TH ST

15TH ST

14TH ST

13TH ST

12TH ST

11TH ST

10TH ST

9TH ST

8TH ST

7TH ST

6TH ST

5TH ST

4TH ST

3RD ST

2ND ST

1ST ST

MINOR ST

RAILROAD AVE

COMMISSION AVE

BAKER ST

1ST AVE

2ND AVE

3RD AVE

4TH AVE

5TH AVE

6TH AVE

7TH AVE

8TH AVE

9TH AVE

10TH AVE

11TH AVE

12TH AVE

13TH AVE

14TH AVE

15TH AVE

16TH AVE

17TH AVE

18TH AVE

19TH AVE

20TH AVE

21ST AVE

22ND AVE

23RD AVE

24TH AVE

25TH AVE

26TH AVE

26TH ST

25TH ST

24TH ST

23TH ST

22TH ST

21TH ST

20TH ST

19TH ST

18TH ST

17TH ST

16TH ST

15TH ST

14TH ST

13TH ST

12TH ST

11TH ST

10TH ST

9TH ST

8TH ST

7TH ST

6TH ST

5TH ST

4TH ST

3RD

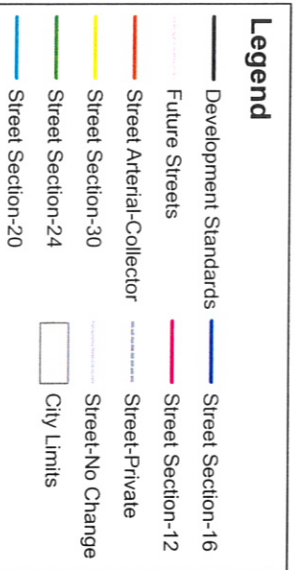

**CITY OF BLACK DIAMOND**  
Street Classification Map  
Transportation Planning Study, September 2008



# BLACK DIAMOND STREET INVENTORY AND TYPICAL SECTION RECOMMENDATIONS LOCAL STREETS

LEGEND:		ST-12	ST-16	ST-20	ST-24	ST-30	DEV STANDARDS	NO CHANGE						
STREET NAME	FROM	TO	ROW WIDTH (FT)	PAVEMENT WIDTH (FT)	ROADWAY SURFACE TYPE	DRAINAGE TYPE	CURB	PEDESTRIAN FACILITIES	ON STREET PARKING	BICYCLE FACILITIES	POWER	STREET CLASSIFICATION (PER DRAFT COMP PLAN)	TYPICAL SECTION FOR DEVELOPMENT	COMMENTS
1ST AVE	2ND AVE	3RD AVE / SR 169	50	38	AC	ENCLOSED	BOTH SIDES	BOTH SIDES	BOTH SIDES	NONE	UNDERGROUND	LOCAL STREET	NO CHANGE	
1ST AVE	3RD AVE / SR 169	PARK ST	60									LOCAL STREET	DEV. STANDARDS	UNOPENED
1ST AVE	BAKER ST	2ND AVE	50	38	AC	ENCLOSED	BOTH SIDES	BOTH SIDES	BOTH SIDES	NONE	UNDERGROUND	LOCAL STREET	NO CHANGE	
1ST AVE	END	BAKER ST	60	9	AC	NONE	NONE	NONE	NONE	NONE	OVERHEAD	LOCAL STREET	ST-12	
218TH AVE SE	SE 289TH ST	SE 292ND ST	60	21	AC	NONE	NONE	NONE	NONE	NONE	OVERHEAD	LOCAL STREET	ST-24	
218TH PL SE	SE 292ND ST	SE 295TH PL	60	20	AC	NONE	NONE	NONE	NONE	NONE	OVERHEAD	LOCAL STREET	ST-24	
220TH PL SE	222ND PL SE	SE 289TH SE	60	22	AC	NONE	NONE	NONE	NONE	NONE	OVERHEAD	LOCAL STREET	ST-24	
222ND PL SE	SE 290TH ST	220TH PL SE	60	23	AC	NONE	NONE	NONE	NONE	NONE	OVERHEAD	LOCAL STREET	ST-24	
225TH AVE SE	SE 302ND ST	SE 300TH ST	60	20	AC	NONE	NONE	NONE	NONE	NONE	OVERHEAD	LOCAL STREET	ST-24	
225TH AVE SE	SE 304TH PL	END	40	16	AC	NONE	NONE	NONE	NONE	NONE	OVERHEAD	LOCAL STREET	ST-20	
225TH PL SE	SE 298TH ST	END	60	20	AC	DITCH	NONE	NONE	NONE	NONE	OVERHEAD	LOCAL STREET	ST-20	
226TH AVE SE	SE 298TH ST	END	60	19	AC	DITCH	NONE	NONE	NONE	NONE	OVERHEAD	LOCAL STREET	ST-24	
227TH PL SE	SE 304TH PL	END	40	15	AC	NONE	NONE	NONE	NONE	NONE	OVERHEAD	LOCAL STREET	ST-16	
227TH PL SE	SE 304TH PL	SE 307TH PL	40	19	AC / GRAVEL	NONE	NONE	NONE	NONE	NONE	OVERHEAD	LOCAL STREET	ST-20	
228TH AVE SE	SE 288TH ST	229TH PL SE	60	22	AC	NONE	NONE	NONE	NONE	NONE	OVERHEAD	LOCAL STREET	ST-24	
229TH AVE SE	229TH PL SE	SE 292ND PL	60	22	AC	NONE	NONE	NONE	NONE	NONE	OVERHEAD	LOCAL STREET	ST-24	
229TH PL SE	228TH AVE SE	END	60	22	AC	NONE	NONE	NONE	NONE	NONE	OVERHEAD	LOCAL STREET	ST-24	
229TH PL SE	SE 307TH PL	END	40	16	AC	NONE	NONE	NONE	NONE	NONE	OVERHEAD	LOCAL STREET	ST-24	
230TH CT SE	SE 288TH ST	END	40	24	AC	ENCLOSED	AC (BOTH SIDES)	NONE	NONE	NONE	UNDERGROUND	LOCAL STREET	NO CHANGE	
232ND AVE SE	SE 288TH ST	290TH ST	60	22	AC	DITCH	NONE	NONE	NONE	NONE	N/A	LOCAL STREET	NO CHANGE	
232ND AVE SE	SE 290TH ST	SE 291ST CT	60	22	AC	NONE	NONE	NONE	NONE	NONE	OVERHEAD	LOCAL STREET	NO CHANGE	
232ND AVE SE	SE 291ST CT	SE 292ND PL	60	22	AC	DITCH	NONE	NONE	NONE	NONE	OVERHEAD	LOCAL STREET	NO CHANGE	
232ND AVE SE	SE 292ND PL	SE 293RD PL	60	22	AC	DITCH	NONE	NONE	NONE	NONE	OVERHEAD	LOCAL STREET	NO CHANGE	
232ND AVE SE	SE 293RD PL	SE 298TH ST	60	18	AC	NONE	NONE	NONE	NONE	NONE	OVERHEAD	LOCAL STREET	ST-20	
232ND AVE SE	SE 298TH ST	232ND PL SE	60	18	AC	NONE	NONE	NONE	NONE	NONE	OVERHEAD	LOCAL STREET	ST-20	
232ND PL SE	232ND AVE SE	234TH AVE SE	60	16	AC	NONE	NONE	NONE	NONE	NONE	OVERHEAD	LOCAL STREET	ST-20	
233RD AVE SE	SE 289TH ST	SE 291ST ST	48	24	AC	ENCLOSED	AC (BOTH SIDES)	NONE	NONE	NONE	UNDERGROUND	LOCAL STREET	NO CHANGE	
233RD AVE SE	SE 293RD PL	END	48	23	AC	ENCLOSED	AC (BOTH SIDES)	NONE	NONE	NONE	UNDERGROUND	LOCAL STREET	NO CHANGE	
234TH AVE SE	232ND PL SE	END	60	16	AC	NONE	NONE	NONE	NONE	NONE	OVERHEAD	LOCAL STREET	ST-20	
234TH AVE SE	SE 288TH ST	SE 289TH ST	60	30	AC	ENCLOSED	AC (BOTH SIDES)	NONE	BOTH SIDES	NONE	UNDERGROUND	LOCAL STREET	NO CHANGE	
234TH AVE SE	SE 289TH ST	SE 291ST ST	60	30	AC	ENCLOSED	AC (BOTH SIDES)	NONE	BOTH SIDES	NONE	UNDERGROUND	LOCAL STREET	NO CHANGE	
235TH AVE SE	SE 293RD PL	SE 298TH ST	60	22	GRAVEL / AC	NONE / ENCLOSED	N / AC, BS	NONE	NONE	NONE	OVERHEAD / UNDERGROUND	LOCAL STREET	NO CHANGE	N SECTION IMPROVED
236TH AVE SE	SE 291ST ST	SE 293RD PL	30	24	AC	ENCLOSED	AC (SOUTH)	NONE	NONE	NONE	UNDERGROUND	LOCAL STREET	NO CHANGE	



BLACK DIAMOND STREET INVENTORY AND TYPICAL SECTION RECOMMENDATIONS  
LOCAL STREETS

LEGEND:														
ST-12		ST-16		ST-20	ST-24	ST-30	DEV STANDARDS	NO CHANGE						
STREET NAME	FROM	TO	ROW WIDTH (FT)	PAVEMENT WIDTH (FT)	ROADWAY SURFACE TYPE	DRAINAGE TYPE	CURB	PEDESTRIAN FACILITIES	ON STREET PARKING	BICYCLE FACILITIES	POWER	STREET CLASSIFICATION (PER DRAFT COMP PLAN)	TYPICAL SECTION FOR DEVELOPMENT	COMMENTS
289TH ST, SE	220TH PL SE	218TH AVE SE	60	22	AC	NONE	NONE	NONE	NONE	NONE	OVERHEAD	LOCAL STREET	ST-24	
289TH ST, SE	234TH AVE SE	233RD AVE SE	48	24	AC	ENCLOSED	AC (BOTH SIDES)	NONE	NONE	NONE	UNDERGROUND	LOCAL STREET	NO CHANGE	
289TH ST, SE	234TH AVE SE	END	48	25	AC	ENCLOSED	AC (BOTH SIDES)	NONE	NONE	NONE	UNDERGROUND	LOCAL STREET	NO CHANGE	
290TH ST, SE	224TH AVE SE	222ND PL SE	60	22	AC	NONE	NONE	NONE	NONE	NONE	OVERHEAD	LOCAL STREET	ST-24	
290TH ST, SE	232ND AVE SE	END	40	22	AC	ENCLOSED	AC (BOTH SIDES)	NONE	NONE	NONE	UNDERGROUND	LOCAL STREET	NO CHANGE	
291ST CT, SE	232ND AVE SE	END	40	22	AC	ENCLOSED	AC (BOTH SIDES)	NONE	NONE	NONE	UNDERGROUND	LOCAL STREET	NO CHANGE	
291ST ST, SE	233RD AVE SE	234TH AVE SE	48	24	AC	ENCLOSED	AC (BOTH SIDES)	NONE	NONE	NONE	UNDERGROUND	LOCAL STREET	NO CHANGE	
292ND PL, SE	229TH AVE SE	232ND AVE SE	60	22	AC	NONE	NONE	NONE	NONE	NONE	OVERHEAD	LOCAL STREET	ST-24	
292ND ST, SE	216TH AVE SE	218TH AVE, SE	60	20	AC	NONE	NONE	NONE	NONE	NONE	OVERHEAD	LOCAL STREET	ST-30	
293RD PL, SE	232ND AVE SE	233RD AVE SE	60	32	AC	ENCLOSED	AC (BOTH SIDES)	NONE	NONE	NONE	UNDERGROUND	LOCAL STREET	NO CHANGE	
293RD PL, SE	233RD AVE SE	235TH AVE SE	60	32	AC	ENCLOSED	AC (BOTH SIDES)	NONE	BOTH SIDES	NONE	UNDERGROUND	LOCAL STREET	NO CHANGE	
293RD PL, SE	235TH AVE SE	236TH AVE SE	60	32	AC	ENCLOSED	AC (BOTH SIDES)	NONE	BOTH SIDES	NONE	UNDERGROUND	LOCAL STREET	NO CHANGE	
295TH PL, SE	218TH PL SE	SE 296TH ST	60	22	AC	NONE	NONE	NONE	NONE	NONE	OVERHEAD	LOCAL STREET	ST-24	
296TH ST, SE	224TH AVE SE	END	60	18	AC	NONE	NONE	NONE	NONE	NONE	OVERHEAD	LOCAL STREET	ST-24	
297TH ST, SE	224TH AVE SE	SE 298TH ST	60	18	AC	DITCH	NONE	NONE	NONE	NONE	OVERHEAD	LOCAL STREET	ST-24	
298TH ST, SE	232ND AVE SE	235TH AVE SE	60	20	GRAVEL	DITCH	NONE	NONE	NONE	NONE	OVERHEAD	LOCAL STREET	ST-24	
298TH ST, SE	SE 297TH ST	226TH AVE SE	60	18	AC	NONE	NONE	NONE	NONE	NONE	OVERHEAD	LOCAL STREET	ST-24	
299TH ST, SE	235TH AVE SE	END	60	20	GRAVEL	NONE	NONE	NONE	NONE	NONE	OVERHEAD	LOCAL STREET	ST-24	
2ND AVE	BAKER ST	LAWSON ST	30	19	AC	NONE	NONE	NONE	NONE	NONE	OVERHEAD	LOCAL STREET	ST-24	
2ND AVE	LAWSON ST	1ST AVE	50	38	AC	ENCLOSED	BOTH SIDES	WEST SIDE	BOTH SIDES	NONE	UNDERGROUND	LOCAL STREET	NO CHANGE	
2ND AVE	PARK ST	32432 2ND AVE	30-40	16	AC	NONE	NONE	NONE	NONE	NONE	OVERHEAD	LOCAL STREET	NO CHANGE	
2ND AVE	32432 2ND AVE	BAKER ST	30-40	16	AC	NONE	NONE	NONE	NONE	NONE	OVERHEAD	LOCAL STREET	ST-20	
300TH ST, SE	224TH AVE SE	END	60	18	AC	NONE	NONE	NONE	NONE	NONE	OVERHEAD	LOCAL STREET	ST-24	
302ND ST, SE	224TH AVE SE	225TH AVE SE	60	20	AC	DITCH	NONE	NONE	NONE	NONE	OVERHEAD	LOCAL STREET	ST-24	
304TH PL, SE	224TH AVE SE	225TH AVE SE	40-60	18	AC	NONE	NONE	NONE	NONE	NONE	OVERHEAD	LOCAL STREET	ST-24	
304TH PL, SE	225TH AVE SE	227TH PL SE	40	20	AC	NONE	NONE	NONE	NONE	NONE	OVERHEAD	LOCAL STREET	ST-24	
307TH PL, SE	224TH AVE SE	229TH PL SE	40-50	20	AC	NONE	NONE	NONE	NONE	NONE	OVERHEAD	LOCAL STREET	ST-24	
312TH ST, SE	228TH AVE SE	END	60	20	AC	NONE	NONE	NONE	NONE	NONE	OVERHEAD	LOCAL STREET	ST-30	
4TH AVE	BAKER ST	LAWSON ST	30	16	AC	NONE	NONE	NONE	NONE	NONE	OVERHEAD	LOCAL STREET	ST-20	
4TH AVE	JAMES ST	PARK ST	40	16	AC	NONE	NONE	NONE	NONE	NONE	OVERHEAD	LOCAL STREET	ST-20	
4TH AVE	PARK ST	BAKER ST	30	16	AC	NONE	NONE	NONE	NONE	NONE	OVERHEAD	LOCAL STREET	ST-20	
5TH AVE	BAKER ST	32322 5TH AVE	40	12	AC	NONE	NONE	NONE	NONE	NONE	OVERHEAD	LOCAL STREET	ST-24	
5TH AVE	32322 5TH AVE	PARK ST	40	12	AC	NONE	NONE	NONE	NONE	NONE	OVERHEAD	LOCAL STREET	DEV. STANDARDS	



# BLACK DIAMOND STREET INVENTORY AND TYPICAL SECTION RECOMMENDATIONS

## LOCAL STREETS

LEGEND:		ST-12	ST-16	ST-20	ST-24	ST-30	DEV STANDARDS	NO CHANGE						
STREET NAME	FROM	TO	ROW WIDTH (FT)	PAVEMENT WIDTH (FT)	ROADWAY SURFACE TYPE	DRAINAGE TYPE	CURB	PEDESTRIAN FACILITIES	ON STREET PARKING	BICYCLE FACILITIES	POWER	STREET CLASSIFICATION (PER DRAFT COMP PLAN)	TYPICAL SECTION FOR DEVELOPMENT	COMMENTS
5TH AVE	LAWSON ST	BAKER ST	40	11	AC	DITCH	NONE	NONE	NONE	NONE	OVERHEAD	LOCAL STREET	ST-24	
5TH AVE	LAWSON ST	PACIFIC AVE	40	23	AC	NONE	NONE	NONE	NONE	NONE	OVERHEAD	LOCAL STREET	ST-24	
5TH AVE	PARK ST	END	40	12	AC	NONE	NONE	NONE	NONE	NONE	OVERHEAD	LOCAL STREET	ST-24	
6TH AVE	BAKER ST	AUBURN / BLACK DIAMOND RD	40	21	AC	DITCH	NONE	NONE	NONE	NONE	OVERHEAD	LOCAL STREET	ST-24	
ALPINE DRIVE	MORGAN DRIVE	UNION DRIVE	20	12	AC	NONE	NONE	NONE	NONE	NONE	OVERHEAD	LOCAL STREET	ST-16	
BAKER STREET	3RD AVE / SR 169	4TH AVE	45	20	AC	NONE	NONE	NONE	NONE	NONE	OVERHEAD	LOCAL STREET	ST-24	
BAKER STREET	4TH AVE	5TH AVE	45	17	AC	NONE	NONE	NONE	NONE	NONE	OVERHEAD	LOCAL STREET	ST-24	
BAKER STREET	5TH AVE	6TH AVE	40	13	AC	DITCH	NONE	NONE	NONE	NONE	OVERHEAD	LOCAL STREET	ST-24	
BOTTS DRIVE	LAWSON ST	END	35	20	AC	DITCH	NONE	NONE	NONE	NONE	OVERHEAD	LOCAL STREET	ST-20	
BRANCH ROAD	ROBERTS DRIVE	MORGAN STREET	50	12-14	AC / GRAVEL	NONE	NONE	NONE	NONE	NONE	OVERHEAD	LOCAL STREET	ST-16	
BRUCKNER'S COURT	BRUCKNER'S WAY	END	50	30	AC	ENCLOSED	CONC	BOTH SIDES	BOTH SIDES	NONE	UNDERGROUND	LOCAL STREET	NO CHANGE	
BRUCKNER'S WAY	BRUCKNER'S COURT	FAIRFAX STREET	50	30	AC	ENCLOSED	CONC	BOTH SIDES	BOTH SIDES	NONE	UNDERGROUND	LOCAL STREET	NO CHANGE	
BRUCKNER'S WAY	FAIRFAX STREET	END	50	30	AC	ENCLOSED	CONC	BOTH SIDES	BOTH SIDES	NONE	UNDERGROUND	LOCAL STREET	NO CHANGE	
BRUCKNER'S WAY	ROBERTS DRIVE	BRUCKNER'S COURT	50	30	AC	ENCLOSED	CONC	BOTH SIDES	BOTH SIDES	NONE	UNDERGROUND	LOCAL STREET	NO CHANGE	
BUENA VISTA DRIVE	MORGAN DRIVE	UNION DRIVE	25	15	AC	NONE	NONE	NONE	NONE	NONE	OVERHEAD	LOCAL STREET	ST-16	
BUENA VISTA DRIVE	UNION DRIVE	HIGHLAND DRIVE	25	16	AC	NONE	NONE	NONE	NONE	NONE	OVERHEAD	LOCAL STREET	ST-16	
COMMISSION ST	RAILROAD AVE	FAVRO ST	40	15	AC	NONE	NONE	NONE	NONE	NONE	OVERHEAD	LOCAL STREET	ST-16	
CUMBERLAND PLACE	KANASKET DR	END	50	36	AC	ENCLOSED	BOTH SIDES	BOTH SIDES	BOTH SIDES	NONE	UNDERGROUND	LOCAL STREET	NO CHANGE	
CUMBERLAND WAY	KANASKET DR	SELLECK PLACE	50	36	AC	ENCLOSED	BOTH SIDES	BOTH SIDES	BOTH SIDES	NONE	UNDERGROUND	LOCAL STREET	NO CHANGE	
CUMBERLAND WAY	SELLECK PLACE	UNNAMED CUL-DE-SAC	50	36	AC	ENCLOSED	BOTH SIDES	BOTH SIDES	BOTH SIDES	NONE	UNDERGROUND	LOCAL STREET	NO CHANGE	
CUMBERLAND WAY	UNNAMED CUL-DE-SAC	KANASKET DR	50	36	AC	ENCLOSED	BOTH SIDES	BOTH SIDES	BOTH SIDES	NONE	UNDERGROUND	LOCAL STREET	NO CHANGE	
DAIL DRIVE	MORGAN DRIVE	UNION DRIVE	20	13	AC	NONE	NONE	NONE	NONE	NONE	OVERHEAD	LOCAL STREET	ST-16	
E SUMMIT DR	N SUMMIT DR	S SUMMIT DR	40	31	AC	ENCLOSED	BOTH SIDES	BOTH SIDES	BOTH SIDES	NONE	UNDERGROUND	LOCAL STREET	NO CHANGE	
FAIRFAX STREET	BRUCKNER'S WAY	END	50	30	AC	ENCLOSED	CONC	BOTH SIDES	BOTH SIDES	NONE	UNDERGROUND	LOCAL STREET	NO CHANGE	
FAIRFAX STREET	SUNNY LANE	BRUCKNER'S WAY	50	30	AC	ENCLOSED	CONC	BOTH SIDES	BOTH SIDES	NONE	UNDERGROUND	LOCAL STREET	NO CHANGE	
FAVRO STREET	MERINO ST	COMMISSION ST	30	15	AC	NONE	NONE	NONE	NONE	NONE	UNDERGROUND	LOCAL STREET	ST-16	
FRANKLIN DR	W SUMMIT DR	E SUMMIT DR	40	31	AC	ENCLOSED	BOTH SIDES	BOTH SIDES	BOTH SIDES	NONE	UNDERGROUND	LOCAL STREET	NO CHANGE	
HIGHLAND DR	BUENA VISTA DR	END	20	12	AC	NONE	NONE	NONE	NONE	NONE	OVERHEAD	LOCAL STREET	ST-12	
HYDE AVENUE	MASON STREET	END	40	30	AC	ENCLOSED	BOTH SIDES	BOTH SIDES	BOTH SIDES	NONE	UNDERGROUND	LOCAL STREET	NO CHANGE	
JAMES STREET	3RD AVE / SR 169	4TH AVE	40	16	AC	NONE	NONE	NONE	NONE	NONE	OVERHEAD	LOCAL STREET	ST-20	
KANASKET DR	BLACK DIAMOND - RAVENSDALE RD	CUMBERLAND WAY	60	40	AC	ENCLOSED	BOTH SIDES	BOTH SIDES	BOTH SIDES	NONE	UNDERGROUND	LOCAL STREET	NO CHANGE	
KANASKET DR	CUMBERLAND PL	END	60	40	AC	ENCLOSED	BOTH SIDES	BOTH SIDES	BOTH SIDES	NONE	UNDERGROUND	LOCAL STREET	NO CHANGE	
KANASKET DR	CUMBERLAND WAY	PALMER PLACE	60	40	AC	ENCLOSED	BOTH SIDES	BOTH SIDES	BOTH SIDES	NONE	UNDERGROUND	LOCAL STREET	NO CHANGE	



# BLACK DIAMOND STREET INVENTORY AND TYPICAL SECTION RECOMMENDATIONS

## LOCAL STREETS

LEGEND:		ST-12	ST-16	ST-20	ST-24	ST-30	DEV STANDARDS	NO CHANGE						
STREET NAME	FROM	TO	ROW WIDTH (FT)	PAVEMENT WIDTH (FT)	ROADWAY SURFACE TYPE	DRAINAGE TYPE	CURB	PEDESTRIAN FACILITIES	ON STREET PARKING	BICYCLE FACILITIES	POWER	STREET CLASSIFICATION (PER DRAFT COMP PLAN)	TYPICAL SECTION FOR DEVELOPMENT	COMMENTS
KANASKET DR	PALMER PLACE	CUMBERLAND PL	60	40	AC	ENCLOSED	BOTH SIDES	BOTH SIDES	BOTH SIDES	NONE	UNDERGROUND	LOCAL STREET	NO CHANGE	
LYNCH LANE	ROBERTS DRIVE	END	30	22	AC	ENCLOSED	BOTH SIDES	WEST SIDE	NONE	NONE	UNDERGROUND	LOCAL STREET	NO CHANGE	
MASON STREET	ABRAMS DRIVE	HYDE AVE	50	36	AC	ENCLOSED	BOTH SIDES	BOTH SIDES	BOTH SIDES	NONE	UNDERGROUND	LOCAL STREET	NO CHANGE	
MASON STREET	HYDE AVE	END	50	36	AC	ENCLOSED	BOTH SIDES	BOTH SIDES	BOTH SIDES	NONE	UNDERGROUND	LOCAL STREET	NO CHANGE	
MCKAY LANE	NEWCASTLE DR	NEWCASTLE DR	50	36	AC	ENCLOSED	BOTH SIDES	BOTH SIDES	BOTH SIDES	NONE	UNDERGROUND	LOCAL STREET	NO CHANGE	
MERINO STREET	FAVRO ST	END	30	15	AC	NONE	NONE	NONE	NONE	NONE	UNDERGROUND	LOCAL STREET	ST-16	
MERINO STREET	RAILROAD AVE	FAVRO ST	20-30	16	AC	NONE	NONE	NONE	NONE	NONE	OVERHEAD	LOCAL STREET	ST-16	
MORGAN DRIVE	ALPINE DRIVE	BUENA VISTA DRIVE	20	14	AC	NONE	NONE	NONE	NONE	NONE	OVERHEAD	LOCAL STREET	ST-16	
MORGAN DRIVE	BUENA VISTA DR	END	20									LOCAL STREET	DEV. STANDARDS	UNOPENED
MORGAN DRIVE	DAIL DRIVE	END	25	12	AC	NONE	NONE	NONE	NONE	NONE	OVERHEAD	LOCAL STREET	ST-16	
MORGAN DRIVE	ROBERTS DRIVE	DAIL DRIVE	25	12	AC	NONE	NONE	NONE	NONE	NONE	OVERHEAD	LOCAL STREET	ST-16	
MORGAN DRIVE	ROBERTS DRIVE	ALPINE DRIVE	25	15	AC	NONE	NONE	NONE	NONE	NONE	OVERHEAD	LOCAL STREET	ST-16	
NEWCASTLE DRIVE	LAWSON ST	MCKAY LANE	50	36	AC	ENCLOSED	BOTH SIDES	BOTH SIDES	BOTH SIDES	NONE	UNDERGROUND	LOCAL STREET	NO CHANGE	
NEWCASTLE DRIVE	MCKAY LANE	END	50	36	AC	ENCLOSED	BOTH SIDES	BOTH SIDES	BOTH SIDES	NONE	UNDERGROUND	LOCAL STREET	NO CHANGE	
NEWCASTLE DRIVE	MCKAY LANE	MCKAY LANE	50	36	AC	ENCLOSED	BOTH SIDES	BOTH SIDES	BOTH SIDES	NONE	UNDERGROUND	LOCAL STREET	NO CHANGE	
OLD LAWSON RD	3RD AVE / SR 169	END	40	15	GRAVEL	NONE	NONE	NONE	NONE	NONE	OVERHEAD	LOCAL STREET	ST-20	
PALMER PLACE	KANASKET DR	END	50	36	AC	ENCLOSED	BOTH SIDES	BOTH SIDES	BOTH SIDES	NONE	UNDERGROUND	LOCAL STREET	NO CHANGE	
PARK STREET	2ND AVE	3RD AVE / SR 169	35	18	AC	NONE	NONE	NONE	NONE	NONE	OVERHEAD	LOCAL STREET	ST-20	
PARK STREET	3RD AVE / SR 169	4TH AVE	40	30	AC	ENCLOSED	NONE	NONE	NONE	NONE	OVERHEAD	LOCAL STREET	ST-30	
PARK STREET	4TH AVE	5TH AVE	40									LOCAL STREET	DEV. STANDARDS	UNOPENED
RAILROAD AVE	BAKER ST	MERINO ST	80	30	AC	NONE	NONE	NONE	BOTH SIDES	NONE	OVERHEAD	LOCAL STREET	NO CHANGE	
RAILROAD AVE	END	BAKER ST	50	18	AC	DITCH	NONE	NONE	NONE	NONE	OVERHEAD	LOCAL STREET	NO CHANGE	
SELLECK PLACE	CUMBERLAND WAY	END	50	36	AC	ENCLOSED	BOTH SIDES	BOTH SIDES	BOTH SIDES	NONE	UNDERGROUND	LOCAL STREET	NO CHANGE	
SUMMIT DR, S	3RD AVE / SR 169	E SUMMIT DR	40	31	AC	ENCLOSED	BOTH SIDES	BOTH SIDES	BOTH SIDES	NONE	UNDERGROUND	LOCAL STREET	NO CHANGE	
SUMMIT DR, S	E SUMMIT DR	W SUMMIT DR	40	31	AC	ENCLOSED	BOTH SIDES	BOTH SIDES	BOTH SIDES	NONE	UNDERGROUND	LOCAL STREET	NO CHANGE	
SUMMIT DR, W	S SUMMIT DR	N SUMMIT DR	40	31	AC	ENCLOSED	BOTH SIDES	BOTH SIDES	BOTH SIDES	NONE	UNDERGROUND	LOCAL STREET	NO CHANGE	
SUNNY LANE	FAIRFAX STREET	END	60	40	AC	ENCLOSED	AC (BOTH SIDES)	BOTH SIDES	BOTH SIDES	NONE	UNDERGROUND	LOCAL STREET	NO CHANGE	
SUNNY LANE	ROBERTS DRIVE	FAIRFAX STREET	60	40	AC	ENCLOSED	AC (BOTH SIDES)	BOTH SIDES	BOTH SIDES	NONE	UNDERGROUND	LOCAL STREET	NO CHANGE	
TERRACE PLACE	MORGAN STREET	END	50	32	AC	ENCLOSED	BOTH SIDES	WEST SIDE	BOTH SIDES	NONE	UNDERGROUND	LOCAL STREET	NO CHANGE	
UNION DRIVE	ALPINE DRIVE	BUENA VISTA DRIVE	20	14	AC	NONE	NONE	NONE	NONE	NONE	OVERHEAD	LOCAL STREET	ST-16	
UNION DRIVE	BUENA VISTA DR	END	20	12	AC	NONE	NONE	NONE	NONE	NONE	OVERHEAD	LOCAL STREET	ST-16	
UNION DRIVE	DAIL DRIVE	END	20									LOCAL STREET	ST-16	UNOPENED
UNION DRIVE	ROBERTS DRIVE	DAIL DRIVE	20-40	12	AC	NONE	NONE	NONE	NONE	NONE	OVERHEAD	LOCAL STREET	ST-16	



BLACK DIAMOND STREET INVENTORY AND TYPICAL SECTION RECOMMENDATIONS  
LOCAL STREETS

LEGEND:		ST-12	ST-16	ST-20	ST-24	ST-30	DEV STANDARDS	NO CHANGE						
STREET NAME	FROM	TO	ROW WIDTH (FT)	PAVEMENT WIDTH (FT)	ROADWAY SURFACE TYPE	DRAINAGE TYPE	CURB	PEDESTRIAN FACILITIES	ON STREET PARKING	BICYCLE FACILITIES	POWER	STREET CLASSIFICATION (PER DRAFT COMP PLAN)	TYPICAL SECTION FOR DEVELOPMENT	COMMENTS
UNION DRIVE	ROBERTS DRIVE	ALPINE DRIVE	20	14	AC	NONE	NONE	NONE	NONE	NONE	OVERHEAD	LOCAL STREET	ST-16	
UNNAMED STREET (ST. B CHURCH)	6TH AVE	END	20	28	AC	ENCLOSED	N SIDE	N SIDE	NONE	NONE	UNDERGROUND	LOCAL STREET	NO CHANGE	
WAGON ROAD	ROBERTS DRIVE	END	20	31	AC	ENCLOSED	BOTH SIDES	BOTH SIDES	BOTH SIDES	NONE	UNDERGROUND	LOCAL STREET	NO CHANGE	



**BLACK DIAMOND STREET INVENTORY**  
**COLLECTORS, MINOR ARTERIALS, PRINCIPAL ARTERIALS**

STREET NAME	FROM	TO	ROW WIDTH (FT)	PAVEMENT WIDTH (FT)	ROADWAY SURFACE TYPE	DRAINAGE TYPE	CURB	PEDESTRIAN FACILITIES	ON STREET PARKING	BICYCLE FACILITIES	POWER	STREET CLASSIFICATION (PER DRAFT COMP PLAN)
216TH AVE SE	SE 288TH ST	SE 289TH PL	60-80	47	AC	ENCLOSED	WEST SIDE	WEST SIDE	WEST SIDE	NONE	OVERHEAD	MINOR ARTERIAL
216TH AVE SE	SE 289TH CT	SE 290TH CT	60-80	47	AC	ENCLOSED	WEST SIDE	WEST SIDE	WEST SIDE	NONE	OVERHEAD	MINOR ARTERIAL
216TH AVE SE	SE 290TH CT	SE 292ND ST	60-80	47	AC	ENCLOSED	WEST SIDE	WEST SIDE	WEST SIDE	NONE	OVERHEAD	MINOR ARTERIAL
216TH AVE SE	SE 292ND ST	SE 293RD PL	60-80	32	AC	DITCH	NONE	NONE	NONE	NONE	OVERHEAD	MINOR ARTERIAL
216TH AVE SE	23	224TH AVE SE	60	32	AC	NONE	NONE	NONE	NONE	NONE	OVERHEAD	MINOR ARTERIAL
224TH AVE SE	SE 288TH ST	SE 290TH ST	60	22	AC	NONE	NONE	NONE	NONE	NONE	N/A	MINOR ARTERIAL
224TH AVE SE	SE 296TH ST	SE 297TH ST	60-80	32	AC	NONE	NONE	NONE	NONE	NONE	OVERHEAD	MINOR ARTERIAL
224TH AVE SE	SE 297TH ST	SE 300TH ST	60	32	AC	NONE	NONE	PAVED SHOULDER	NONE	NONE	OVERHEAD	MINOR ARTERIAL
224TH AVE SE	SE 300TH ST	SE 302ND ST	60	31	AC	NONE	NONE	PAVED SHOULDER	NONE	NONE	OVERHEAD	MINOR ARTERIAL
224TH AVE SE	SE 302ND ST	SE 304TH ST	60	30	AC	NONE	NONE	PAVED SHOULDER	NONE	NONE	OVERHEAD	MINOR ARTERIAL
224TH AVE SE	SE 304TH PL	SE 307TH PL	60	31	AC	NONE	NONE	PAVED SHOULDER	NONE	NONE	OVERHEAD	MINOR ARTERIAL
224TH AVE SE	SE 304TH ST	SE 304TH PL	60	30	AC	NONE	NONE	PAVED SHOULDER	NONE	NONE	OVERHEAD	MINOR ARTERIAL
228th AVE SE	SE 307TH PL	SE 312TH ST	60	36	AC	DITCH	NONE	PAVED SHOULDER	NONE	NONE	OVERHEAD	MINOR ARTERIAL
288TH ST, SE	224TH AVE SW	216TH AVE SE	60	28	AC	NONE	NONE	NONE	NONE	NONE	OVERHEAD	MINOR ARTERIAL
288TH ST, SE	228TH AVE SE	224TH AVE SE	60	40	AC	ENCLOSED	NORTH SIDE	NORTH SIDE	NONE	NONE	UNDERGROUND	MINOR ARTERIAL
288TH ST, SE	228TH AVE SE	228TH AVE SE	60	40	AC	ENCLOSED	NORTH SIDE	NORTH SIDE	NONE	NONE	UNDERGROUND	MINOR ARTERIAL
288TH ST, SE	228TH AVE SE	229TH AVE SE	60	27	AC	ENCLOSED	NONE	NONE	NONE	NONE	OVERHEAD	MINOR ARTERIAL
288TH ST, SE	229th AVE SE	230TH CT SE	60	27	AC	ENCLOSED	NONE	NONE	NONE	NONE	OVERHEAD	MINOR ARTERIAL
288TH ST, SE	230TH CT SE	231ST AVE SE	60	32	AC	NONE	NONE	NONE	NONE	NONE	OVERHEAD	MINOR ARTERIAL
288TH ST, SE	231ST AVE SE	232ND AVE SE	60	28	AC	NONE	NONE	NONE	NONE	NONE	OVERHEAD	MINOR ARTERIAL
288TH ST, SE	232ND AVE SE	234TH AVE SE	60	29	AC	NONE	NONE	NONE	NONE	NONE	OVERHEAD	MINOR ARTERIAL
288TH ST, SE	234TH AVE SE	235ST AVE SE	60	32	AC	DITCH	NONE	NONE	NONE	NONE	OVERHEAD	MINOR ARTERIAL
288TH ST, SE	235TH AVE SE	236TH AVE SE	60	31	AC	DITCH	NONE	NONE	NONE	NONE	OVERHEAD	MINOR ARTERIAL
3RD AVENUE / SR 169	BAKER ST	BAKER ST	60	30	AC	ENCLOSED	EAST SIDE	EAST SIDE	NONE	NONE	OVERHEAD	PRINCIPAL ARTERIAL
3RD AVENUE / SR 169	BAKER ST	LAWSON ST	60	30	AC	ENCLOSED	EAST SIDE	EAST SIDE	NONE	NONE	OVERHEAD	PRINCIPAL ARTERIAL
3RD AVENUE / SR 169	CITY LIMITS	S SUMMIT DR	100	38	AC	DITCH	NONE	NONE	NONE	NONE	OVERHEAD	PRINCIPAL ARTERIAL
3RD AVENUE / SR 169	FIRST AVE	JONES LAKE ROAD	100-110	40	AC	DITCH	NONE	NONE	NONE	NONE	OVERHEAD	PRINCIPAL ARTERIAL
3RD AVENUE / SR 169	JAMES ST	PARK ST	60	30	AC	ENCLOSED	EAST SIDE	EAST SIDE	NONE	NONE	OVERHEAD	PRINCIPAL ARTERIAL
3RD AVENUE / SR 169	LAWSON ST	1ST AVE	60-80	36	AC	DITCH	NONE	NONE	NONE	NONE	OVERHEAD	PRINCIPAL ARTERIAL
3RD AVENUE / SR 169	PARK ST	BAKER ST	60	30	AC	ENCLOSED	EAST SIDE	EAST SIDE	NONE	NONE	OVERHEAD	PRINCIPAL ARTERIAL
3RD AVENUE / SR 169	PARK ST	PARK ST	60	30	AC	ENCLOSED	EAST SIDE	EAST SIDE	NONE	NONE	OVERHEAD	PRINCIPAL ARTERIAL
3RD AVENUE / SR 169	ROBERTS DRIVE	JAMES ST	60	29	AC	DITCH	NONE	NONE	NONE	NONE	OVERHEAD	PRINCIPAL ARTERIAL



**BLACK DIAMOND STREET INVENTORY  
COLLECTORS, MINOR ARTERIALS, PRINCIPAL ARTERIALS**

STREET NAME	FROM	TO	ROW WIDTH (FT)	PAVEMENT WIDTH (FT)	ROADWAY SURFACE TYPE	DRAINAGE TYPE	CURB	PEDESTRIAN FACILITIES	ON STREET PARKING	BICYCLE FACILITIES	POWER	STREET CLASSIFICATION (PER DRAFT COMP PLAN)
3RD AVENUE / SR 169	S OF MOBILE HOME PARK	ROBERTS DR	60	36	AC	DITCH	NONE	NONE	NONE	NONE	OVERHEAD	PRINCIPAL ARTERIAL
3RD AVENUE / SR 169	S SUMMIT DR	S OF MOBILE HOME PARK	100	38	AC	DITCH	NONE	NONE	NONE	NONE	OVERHEAD	PRINCIPAL ARTERIAL
ABRAMS DRIVE	MASON STREET	END	40-50	30-18	AC / GRAVEL	DITCH	NONE	NONE	NONE	NONE	OVERHEAD	COLLECTOR
ABRAMS DRIVE	MORGAN STREET	MASON STREET	40-50	32	AC	ENCLOSED / DITCH	WEST SIDE- AC	AC WALK	NONE	NONE	OVERHEAD	COLLECTOR
BAKER STREET	1ST AVE	2ND AVE	60	27	AC	ENCLOSED	NORTH SIDE	NORTH SIDE	NONE	NONE	OVERHEAD	COLLECTOR
BAKER STREET	2ND AVE	3RD AVE / SR 169	60	34	AC	ENCLOSED	NORTH SIDE	NORTH SIDE	NONE	NONE	OVERHEAD	COLLECTOR
BAKER STREET	RAILROAD AVE	1ST AVE	60	34	AC	ENCLOSED	NORTH SIDE	NORTH SIDE	NORTH SIDE	NONE	OVERHEAD	COLLECTOR
ENUMCLAW / BLACK DIAMOND ROAD	JONES LAKE RD	CITY LIMITS	100-135	38	AC	DITCH	NONE	NONE	NONE	NONE	OVERHEAD	PRINCIPAL ARTERIAL
JONES LAKE ROAD	MERINO ST	3RD AVE / SR 169	60	20	AC	DITCH	NONE	NONE	NONE	NONE	OVERHEAD	COLLECTOR
LAWSON STREET	2ND AVE	3RD AVE / SR 169	50	22	AC	NONE	NONE	NONE	NONE	NONE	OVERHEAD	MINOR ARTERIAL
LAWSON STREET	3RD AVE / SR 169	4TH AVE	60	20	CONC	NONE	NONE	NONE	NONE	NONE	OVERHEAD	MINOR ARTERIAL
LAWSON STREET	4TH AVE	5TH AVE	60	20	CONC	NONE	NONE	NONE	NONE	NONE	OVERHEAD	MINOR ARTERIAL
LAWSON STREET	5TH AVE	6TH AVE	60	21	CONC	CURB - NORTH SIDE	NORTH SIDE	NONE	NONE	NONE	OVERHEAD	MINOR ARTERIAL
LAWSON STREET	6TH AVE	NEWCASTLE DRIVE	60	20	CONC	NONE	NONE	NONE	NONE	NONE	OVERHEAD	MINOR ARTERIAL
LAWSON STREET	NEWCASTLE DRIVE	CITY LIMITS	60	23	AC	DITCH	NONE	NONE	NONE	NONE	OVERHEAD	MINOR ARTERIAL
MAPLE VALLEY - LAKE SAWYER ROAD	ROBERTS DRIVE	SE 312TH ST	60	31	AC	DITCH	NONE	PAVED SHOULDER	NONE	NONE	OVERHEAD	MINOR ARTERIAL
MORGAN STREET	ABRAMS DRIVE	1ST AVE SE	40-60	24	AC	ENCLOSED	NORTH SIDE	NORTH SIDE	NONE	NONE	OVERHEAD	COLLECTOR
MORGAN STREET	ROBERTS DRIVE	TERRACE PLACE	60	22	AC	NONE	NONE	NONE	NONE	NONE	OVERHEAD	COLLECTOR
MORGAN STREET	TERRACE PLACE	ABRAMS DR	40-60	23	AC	DITCH	NONE	NONE	NONE	NONE	OVERHEAD	COLLECTOR
ROBERTS DRIVE	BLACK DIAMOND LANE	BRANCH ROAD	60	20	CONC	NONE	NONE	NONE	NONE	NONE	OVERHEAD	MINOR ARTERIAL
ROBERTS DRIVE	BRANCH ROAD	MORGAN ST	60	20	CONC	DITCH	NONE	NONE	NONE	NONE	OVERHEAD	MINOR ARTERIAL
ROBERTS DRIVE	BRUCKNER'S WAY	SUNNY LANE	80	30	CONC / AC	ENCLOSED	NORTH SIDE	NORTH SIDE	NONE	NONE	UNDERGROUND	MINOR ARTERIAL
ROBERTS DRIVE	MAPLE VALLEY - LAKE SAWYER ROAD	BRUCKNER'S WAY	60-70	28	AC	NONE	NONE	NONE	NONE	NONE	OVERHEAD	MINOR ARTERIAL
ROBERTS DRIVE	MAPLE VALLEY - LAKE SAWYER ROAD	CITY LIMITS	60	36	AC	NONE	NONE	NONE	NONE	NONE	OVERHEAD	MINOR ARTERIAL
ROBERTS DRIVE	MORGAN DRIVE	UNION DRIVE	60	20	CONC	NONE	NONE	NONE	NONE	NONE	OVERHEAD	MINOR ARTERIAL
ROBERTS DRIVE	MORGAN STREET	WAGON ROAD	60	20	CONC	DITCH	NONE	NONE	NONE	NONE	OVERHEAD	MINOR ARTERIAL
ROBERTS DRIVE	SUNNY LANE	MORGAN DRIVE	60-70	20	CONC	NONE	NONE	NONE	NONE	NONE	OVERHEAD	MINOR ARTERIAL
ROBERTS DRIVE	UNION DRIVE	BLACK DIAMOND LANE	60	28	CONC / AC	NONE	NONE	NONE	NONE	NONE	OVERHEAD	MINOR ARTERIAL
ROBERTS DRIVE	WAGON ROAD	BLACK DIAMOND RENTON ROAD	60	20	CONC	NONE	NONE	NONE	NONE	NONE	OVERHEAD	MINOR ARTERIAL